

# NORFOLK & WESTERN RAILWAY COMPANY

## TRACK CHART

### SCIOTO DIVISION

#### PORTSMOUTH TO CINCINNATI



Scale: Hor. 1" = 4000'  
Ver. 1" = 100'

Office of Chief Engineer, Roanoke Va., July 1, 1927

NOTE:

Elevations are Base of Rail.  
Ruling Grades are shown on the profile in heavier lines than other grades.  
Numbers on grade line show percent of rise or fall.

#### LEGEND

- 100 Lb. Rail Shown  Rail Laid Feb. 1926
- 130 Lb.PS. " 
- 130 Lb.HF. " 
- 131 Lb. " 

132 Lb. RE. Rail Shown 

NOTE:  
Car Capacity of Industrial and Storage Sidings is based on clear length occupied by 25 ft. cars.  
Car capacity of passing and middle sidings is based on clear length occupied by 30 ft. 4. for engine, caboose and safety and 25 ft. cars.



506  
510 -0.42  
-1.5  
554 0.0  
552 +0.475  
551 +0.3296  
549 0.0  
548 0.0 +0.13  
545 0.0 +0.5  
546 0.0 -0.51  
550 -0.575  
550 0.0  
552 -0.583  
551 +0.25  
547 +0.4  
547 0.0  
-1.7  
644  
651 -1.42  
653 -1.51  
657 -1.42  
670 -1.7  
683 -1.23  
689 -1.1  
694 0.0  
694 -1.492  
700 -1.022  
709 V.C.  
707  
+1.313  
693  
+0.91  
677  
677 0.0  
678 V.C.  
678 +0.655  
670 V.C.  
670 -0.525  
676  
-0.133  
678 V.C.  
676  
+1.72  
680  
+0.994  
604

B&O R.R.  
C&D R.R.  
12x12 Conc. Box  
June Str.  
Traction Line  
Brick Pav.  
Carriage Pike  
Br. 2097  
6' x 60'  
C.C.C. & St. L.R.R.  
Prosser Ave.  
Laid law (Forest) Ave.  
Underpass  
BERRY'S YARD  
Paddock Road  
Hard Surf.  
Tennessee Ave.  
17' x 97'  
Br. 209A  
10 Arch. 35' BR to CK.  
Reading Ave.  
Br. 2095  
9' x 18'  
Br. 2092  
12' x 27'  
Sherman Ave.  
(Concrete Sid. Grt. Blks W)  
Courtland Ave.  
Br. 2091-33' x 118'  
Hopkins Ave. U.G.  
Williams Ave.  
(Bituminous H. Gravel S. Side)  
Clemens Ave.  
(Asphalt)  
Dana Ave. - Flt. S.  
Sh. Arm Gates - Turn Gt. Rail  
Idlewild Ave.  
Elec. Short Arm Gates  
Montgomery Ave.  
2-Blc. Car Line (Gr. Blks. 4 Asphalt)  
Floral Ave. 3-wvs  
(Asphalt U. Conc. S. Side)  
Duck Ck. Rd. - H.S.  
Br. 2090 U.G. xing  
53' x 330'  
Grovedale Ave.  
Burch Ave. Watchman  
(Asphalt & Brick W. Side)  
Madisonville Pike (Gravel)  
2-Blc. Car Line (Asphalt & Brick)  
Edwards Rd.  
Gravel (Asphalt)  
Michigan Ave. Std. Flashing  
Shaw Ave. Std. Flash. Light Sigs  
Hyde Park Ave. Std. Flashing  
(Asphalt) Light Sigs  
Monteith Ave. Std. Flashing  
(Asphalt) Light Sigs  
Paxton Rd. Std. Flashing Light  
(Asphalt) Sigs  
Br. 2089 - Rail Top  
Br. 2088  
Br. 2087  
Overhead Br.  
Marsburg Ave.  
Hard Surf.  
Br. 2086  
Rail Top  
Eric Ave. H.S.  
Br. 2085

IVORYDALE  
BOND HILL  
IDLEWILD  
NORWOOD  
HYDE PARK  
R107 C-0  
R106 C-1  
R105 C-2  
R104 C-3  
R103 C-4  
R102 C-5  
R101 C-6  
1-23k 1-47  
1-3-11  
3-81  
1-  
2-28  
1-5 P  
4-43-Flt.  
Y.L.  
To Union



+ 0.994  
 604  
 ELEV. 400  
 549

Br# 2080 - Rail Top  
 Br# 2088  
 Br# 2087  
 Overhead Br.  
 Marsburg Ave.  
 Hard Surf.  
 Br# 2084  
 Rail Top  
 Erie Ave. H.S.  
 Br# 2085  
 Rail Top.  
 Hog Back Rd. Imp.  
 Br# 2084 ug. Xing  
 45' x 268'  
 70' x 449'  
 Br# 2083 ug. Xing  
 P.C. & St. L. R.R.  
 Bank Ave.  
 U.G. Xing.  
 Br# 2082 17' x 70'  
 Wooster Pike  
 Hard Surf.

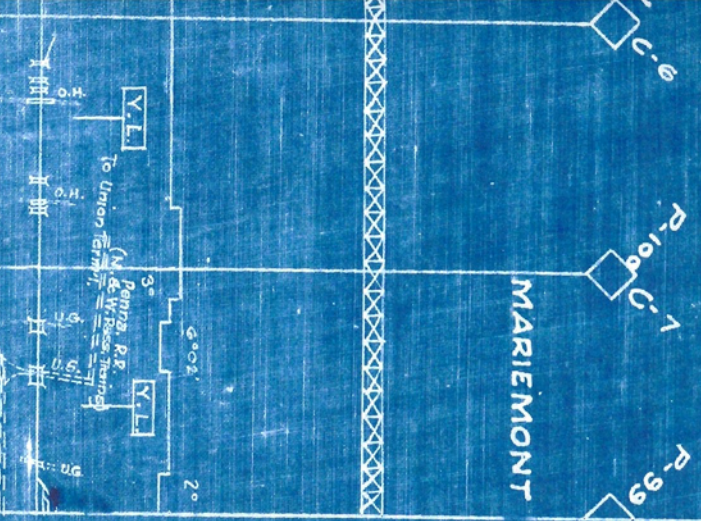

#10250-1

+ 0.995  
 497  
 496 V.C.  
 497.55 0.0625  
 0.57  
 499  
 0.0  
 499  
 -0.156  
 501 0.0  
 501 -0.527  
 507 0.0  
 507 -0.377  
 513 V.C.  
 511 11.089  
 508  
 V.C.  
 507 -1.0  
 512 V.C.  
 512 0.0

**NOTE:-**  
 00 Cincinnati River  
 GO STAGE OF RIVER GAUGE ESTABLISHED BY P.C. JENKIN  
 ON WEST RIVER PIER OF BRIDGE # 2080 = EL. 492.51  
 SEE O.E. LETTER # 103958.  
 00 CLARE GAUGE  
 BR. 2080 EL. 432.51  
 NW 1-27-37 Stage 79.56  
 H.W. 501.5B 3-7-45  
 H.W. 512.47 - 1-27-37  
 H.W. 512.33 - 1-27-37  
 STAGE 79.82  
 0068 EL. 432.51  
 H.W. 512.45 - 1-27-37  
 Stage 79.94

Br# 2081; 15' x 21'  
 R.C. & St. L. R.R.  
 Min. T.L.R. at PRR Xing -  
 EL. 497.55 - Stage 65.04  
 Br# 2080 - 26' x 517' over  
 Little Miami River  
 Min. T.L.R. EL. 498.82  
 = Stage 66.31  
 Co. Rd. (Gravel)  
 Br# 2079  
 22' x 225'  
 Lemon St. (Bituminous)  
 church St. 2-Flash lights  
 Hard Surf. (Bituminous)  
 Round Bottom Rd. (Fla. Lig)  
 Hard Surf. Co. Rd. (Asphalt)

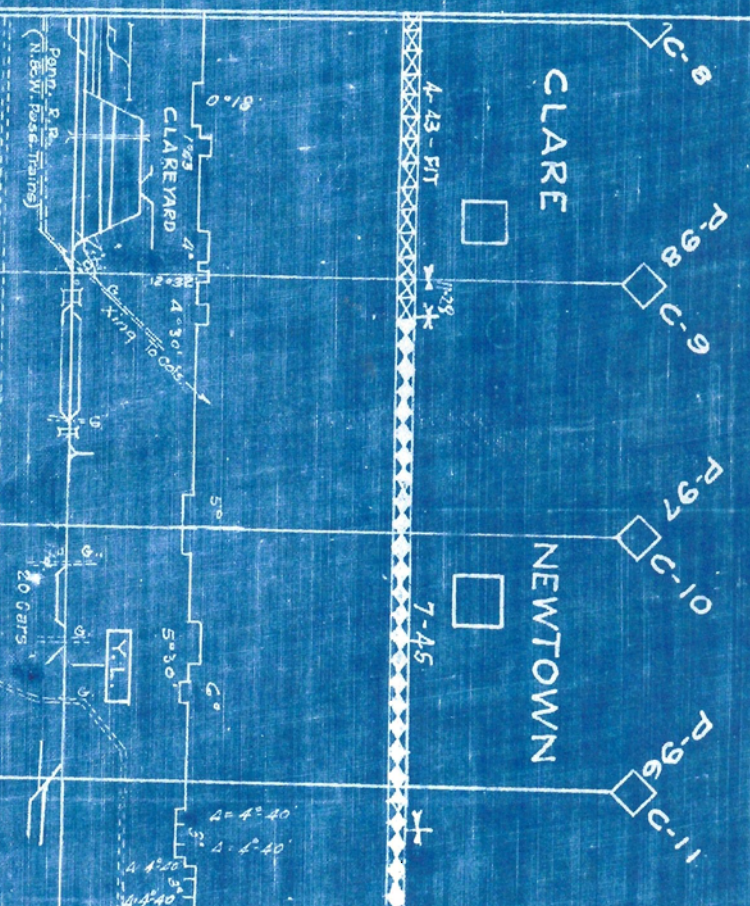



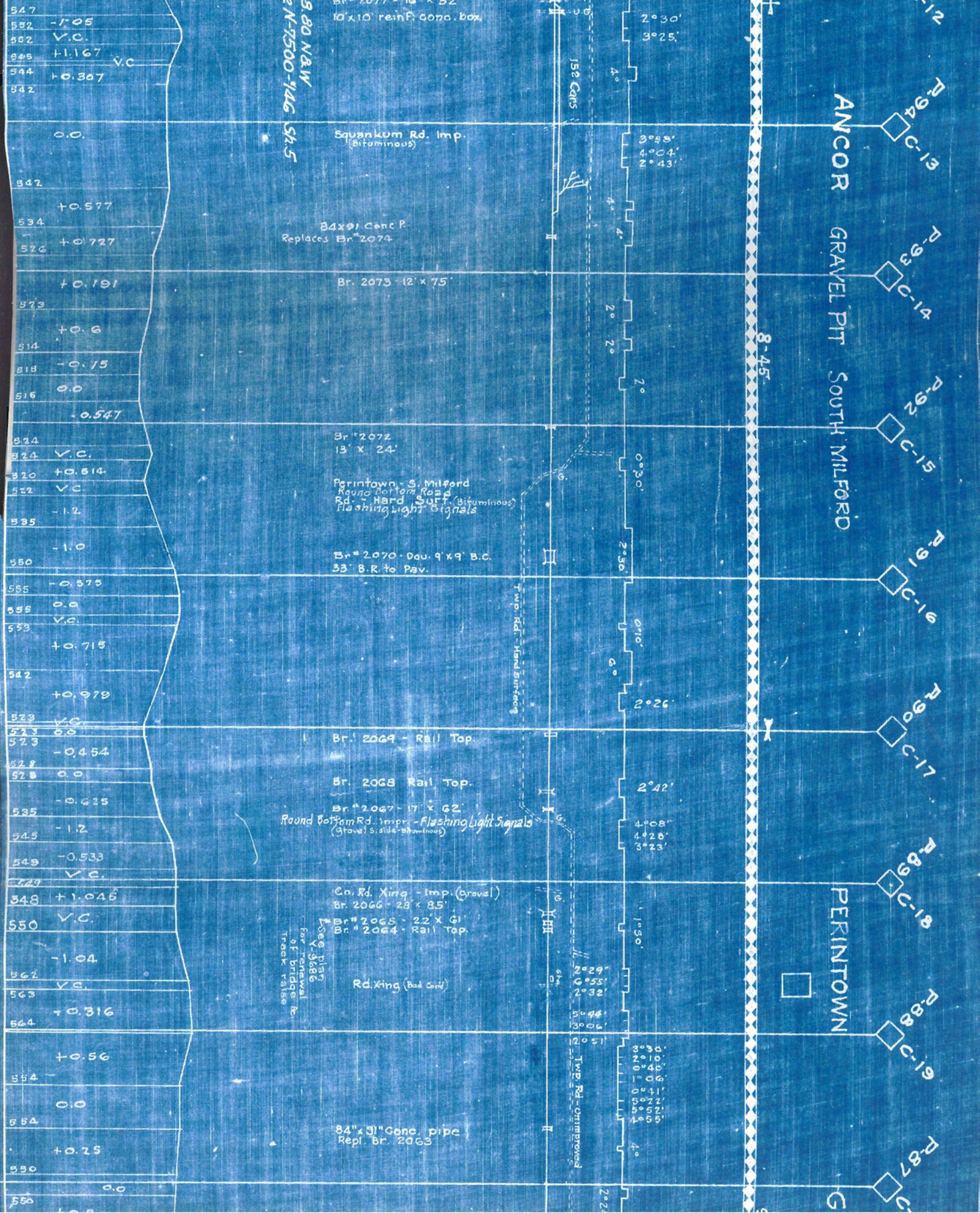

527	-1.05
528	V.C.
529	+1.167
530	V.C.
531	+0.367
532	0.0
533	+0.577
534	+0.727
535	+0.191
536	+0.6
537	-0.15
538	0.0
539	-0.547
540	0.0
541	V.C.
542	+0.514
543	V.C.
544	-1.2
545	-1.0
546	-0.375
547	0.0
548	V.C.
549	+0.715
550	+0.979
551	V.C.
552	0.0
553	-0.454
554	0.0
555	-0.625
556	-1.2
557	-0.533
558	V.C.
559	+1.045
560	V.C.
561	-1.04
562	V.C.
563	+0.316
564	+0.56
565	0.0
566	+0.25
567	0.0
568	+0.25
569	0.0

BR. 2077 - 16' x 52'  
 10' x 10' reinF. conc. box  
 3.80 N&W  
 2-N-7500-146 Sh.5  
 Squunkum Rd. Imp. (Bituminous)  
 84' x 9' Conc P. Replaces Br. 2074  
 Br. 2073 - 12' x 75'  
 Br. 2072 13' x 24'  
 Perintown - S. Milford Round Bottom Road Rd. - Hand Surf. (Bituminous) Flashing Light Signals  
 Br. 2070 - Dou. 9' x 9' B.C. 33' B.R. to Pav.  
 Twp. Rd. - Hand Surface  
 Br. 2069 - Rail Top  
 Br. 2068 Rail Top  
 Br. 2067 - 17' x 62' Round Bottom Rd. Imp. - Flashing Light Signals (Gravel S. side - Bituminous)  
 Co. Rd. Xing - Imp. (Gravel) Br. 2066 - 28' x 85'  
 Br. 2065 - 22' x 61'  
 Br. 2064 - Rail Top  
 Rd. Xing (Bad Grid)  
 Knee Plan for Renewal of bridge No. Y-3086 for Truck raise  
 84' x 31' Conc. pipe Repl. Br. 2063

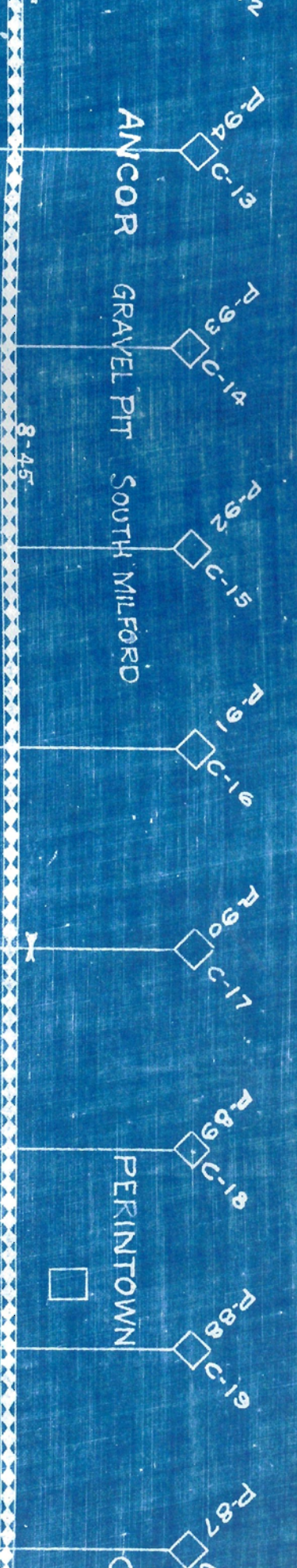
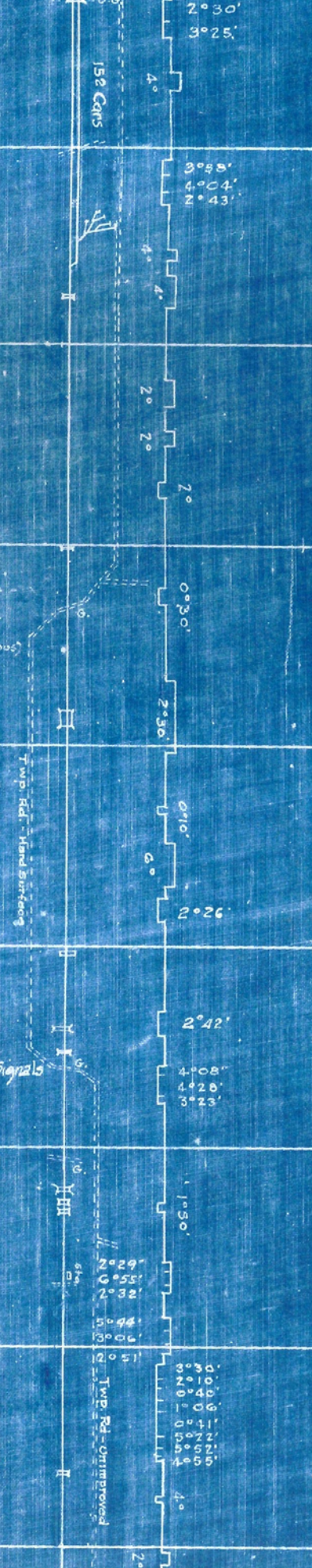



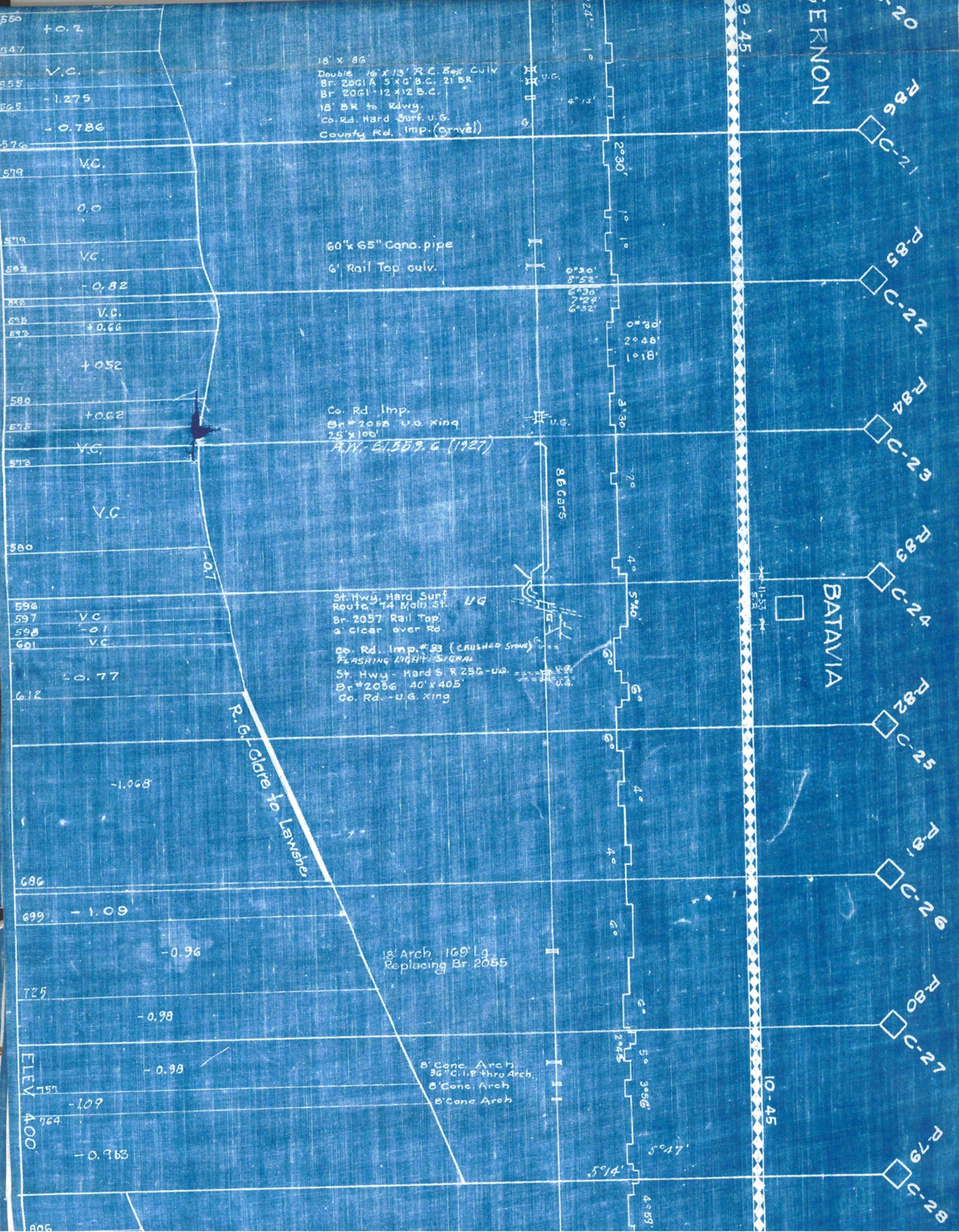

550	+0.2
547	V.C.
555	-1.275
565	-0.786
576	V.C.
579	0.0
579	V.C.
582	-0.82
582	V.C.
585	+0.66
582	+0.52
586	+0.62
575	V.C.
573	V.C.
580	V.C.
596	V.C.
597	V.C.
598	-0.1
601	V.C.
612	0.77
686	-1.068
699	-1.09
725	-0.98
751	-0.98
764	-1.09
806	-0.963

16' x 86'  
 Double 16' x 13' R.C. Box Culv.  
 Br. 2001A 5' x 6' B.C. 21' BR.  
 Br. 2001-12' x 12' B.C.  
 18' BK to Rdwy.  
 Co. Rd. Hard Surf. U.G.  
 County Rd. Imp. (Gravel)

60" x 65" Cano. pipe  
 6' Rail Top culv.

Co. Rd. Imp.  
 Br. #2058 U.G. Xing  
 25' x 100'  
 A.W. E. 1559.6 (1927)

St. Hwy. Hard Surf.  
 Route 74 Main St.  
 Br. 2057 Rail Top  
 a clear over Rd  
 Co. Rd. Imp. #33 (CRUSHED STONE)  
 FLASHING LIGHT SIGNAL  
 St. Hwy. - Hard S. R. 256 - U.G.  
 Br. #2056 40' x 405'  
 Co. Rd. - U.G. Xing

13' Arch 160' Lg.  
 Replacing Br. 2055

8' Conc. Arch.  
 36" C.I.P. thru Arch.  
 8' Conc. Arch.  
 8' Conc. Arch.

R.G. - Clore to Lawster

JERKNON  
 C-20  
 P-86  
 C-21  
 P-85  
 C-22  
 P-84  
 C-23  
 P-83  
 C-24  
 P-82  
 C-25  
 P-81  
 C-26  
 P-80  
 C-27  
 P-79  
 C-28

9-45  
 10-45

224'  
 10'  
 230'  
 10'  
 10'  
 3'30'  
 20'  
 40'  
 5'40'  
 60'  
 60'  
 40'  
 40'  
 60'  
 60'  
 246'  
 50'  
 3'56'  
 5'14'  
 4'59'

U.G.  
 U.G.  
 86' GARS

BATAVIA

ELEV  
 751  
 764  
 806



896	-0.99
854	-0.92
864	-0.82
880	-0.88
890	-0.95
894	V.C.
895	-0.04
894	+0.055
892	+0.19
891	+0.10
887	+0.18
881	+0.146
878	V.C.
870	+0.79
853	+1.03

Br #2053 - Rail Top.  
8' B.R. to Gr.  
Co. Rd. Imp.

Rail Top.  
St. Rt #74 - D.H. Xing.  
(Batavia-Williamsburg Pike)  
Co. Rd. Unimpr.

Public Xing.

Co. Rd (Crushed Stone)

Conc. Arch

Co. Rd. Imp.  
(Gravel)

St. Hwy. Hard Surf.  
Route 133 Main St. 2-WW.S.  
(Bituminous)

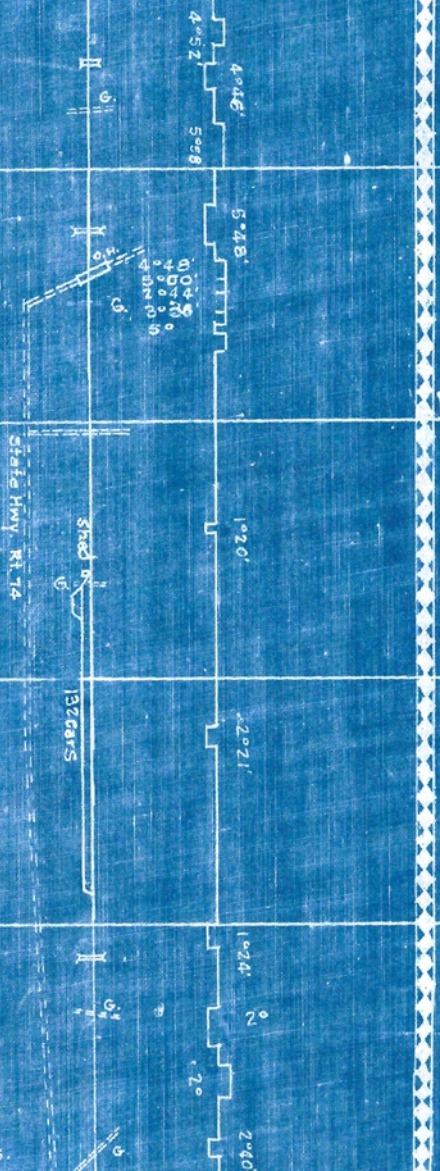

AFTON

WILLIAMSBURG

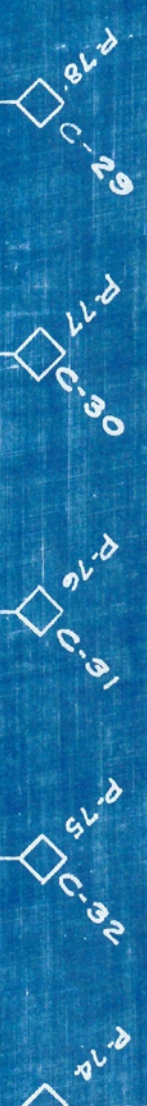

843	+1.38
835	+1.46
822	+1.515
819	V.C.
819	0.0
822	V.C.
847	-1.2
850	-0.75

Bay St. Hard Surf (Bituminous)  
Wig. Wag. Signals

Broadway St. (Not used)  
4th St. (Bituminous) 2-WW.S.  
3rd St. " "  
2nd St. " "  
Front St. (Asphalt) 2-WW.S.  
Br #2056  
34' x 228'  
OH BRIDGE - CO. RD. #41  
Hard Surf.

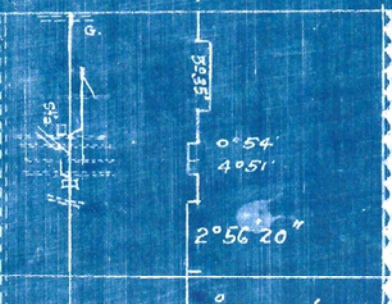



852	-0.75
867	-1.07
872	-0.83
877	-0.357
887	-0.93
898	-1.52
904	-1.0
909	-0.625
	-0.375
918	
921	
924	-0.18
	-0.21
929	
	-0.18
932	
	-0.10
935	
	-0.16
940	
	-0.39
948	V.C.
949	
	0.0
949	
	+0.10
946	V.C.
937	
923	+1.08
	V.C.
925	
935	-1.09
942	V.C.
948	-0.70
951	V.C.
	-0.135
955	

Twp. Rd. (gravel)

Glenmont  
Brown Co.

134 CARS

Co. Rd. (Crushed Stone)

-0.10

Twp. Rd. Unimpr.

-0.16

Co. Rd. (gravel)

-0.39

V.C.

Twp. Rd. Unimpr.

+0.10

V.C.

+1.08

V.C.

-1.09

V.C.

-0.70

V.C.

-0.135

Br. 2049  
20' x 53'  
St. Hwy. Hard Surf.  
U.S. Route 68 (Bituminous)  
Br. 2048 Co. Rd. (gravel)  
6' x 16'

Auto Flashing  
Light Signal

Pr. Rd.

1°24.839'

3°30'

3°30'

3°58'

3-31

X

2°

2°30'

2°03'

3°

2°

2-3

EASTWOOD

MI OREB WHITE

- C-34
- P-72
- C-35
- P-71
- C-36
- P-70
- C-37
- P-69
- C-38
- P-68
- C-39
- P-67
- C-40
- P-66
- C-41
- P-65
- C-42



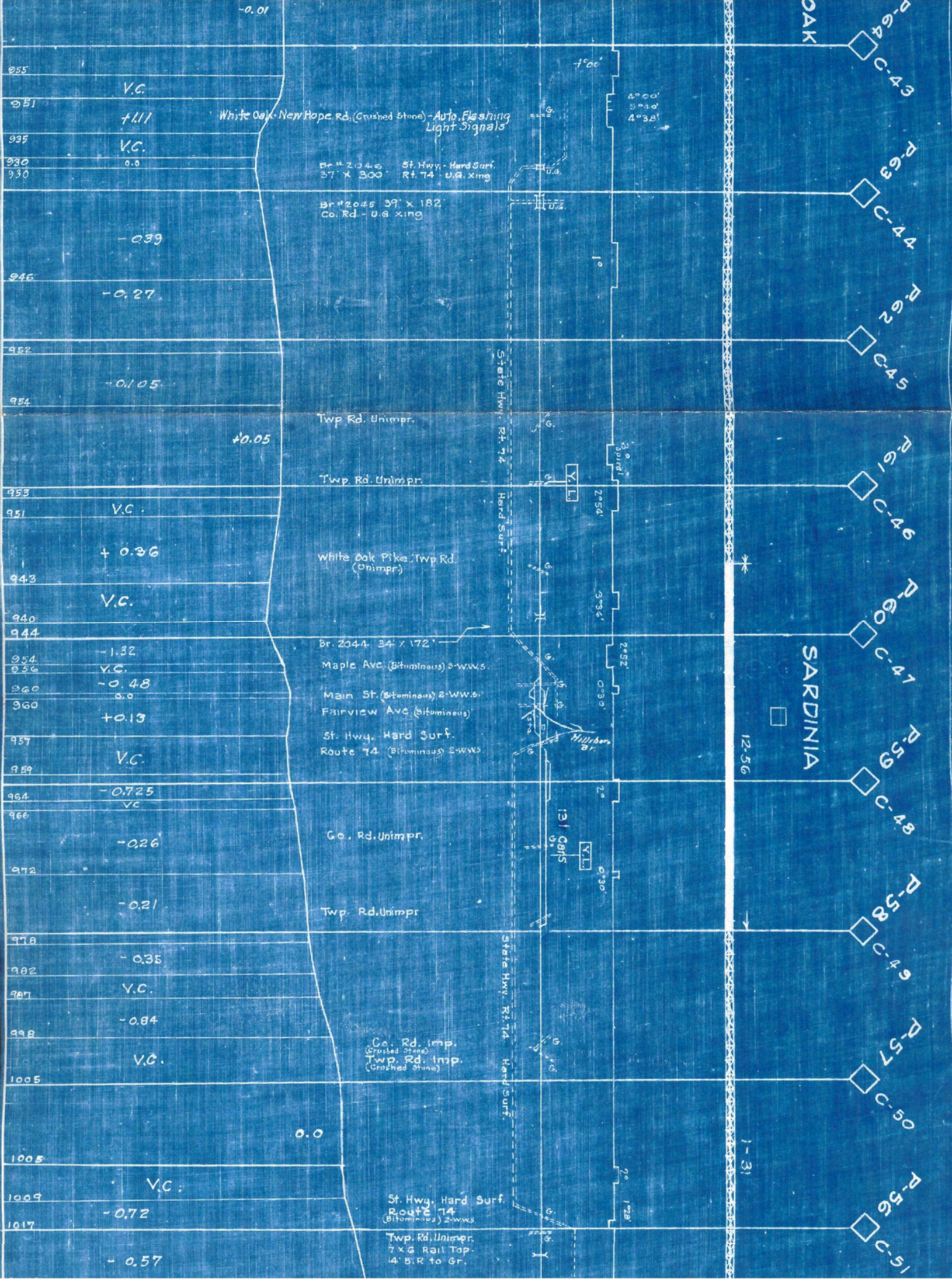

White Oak New Hope Rd. (Crushed Stone) - Auto. Flashing Light Signals

Br #2046 St. Hwy. - Hard Surf.  
37' X 300' Rt. 74 U.G. Xing

Br #2045 39' X 182'  
Co. Rd. - U.G. Xing

Twp. Rd. Unimpr.

Twp. Rd. Unimpr.

White Oak Pike Twp Rd.  
(Unimpr.)

Br. 2044 34' X 172'  
Maple Ave. (Bituminous) 3-WWS.

Main St. (Bituminous) 2-WWS.  
Fairview Ave. (Bituminous)

St. Hwy. Hard Surf.  
Route 74 (Bituminous) 2-WWS.

Co. Rd. Unimpr.

Twp. Rd. Unimpr.

Co. Rd. Imp.  
(Crushed Stone)  
Twp. Rd. Imp.  
(Crushed Stone)

St. Hwy. Hard Surf.  
Route 74  
(Bituminous) 2-WWS

Twp. Rd. Unimpr.  
7 X 6 Rail Top  
14' B.R. to Gr.

SARDINIA

OAK

955  
951  
935  
930  
946  
952  
954  
953  
951  
943  
940  
944  
954  
956  
960  
960  
957  
959  
964  
966  
972  
978  
982  
987  
998  
1005  
1005  
1009  
1017

V.C.  
+1.11  
V.C.  
0.0  
-0.39  
-0.27  
-0.105  
+0.05  
V.C.  
+0.36  
V.C.  
-1.32  
V.C.  
-0.48  
0.0  
+0.13  
V.C.  
-0.725  
V.C.  
-0.26  
-0.21  
-0.35  
V.C.  
-0.84  
V.C.  
0.0  
V.C.  
-0.72  
-0.57

State Hwy. Rt. 74  
Hard Surf.

7'00'  
4'00'  
5'00'  
4'3.8'

3'00'  
2'54'

3'36'  
2'52'

0'30'

2'0'  
0'30'

0'30'

2'0'  
1'28'

P-64  
C-43  
P-63  
C-44  
P-62  
C-45  
P-61  
C-46  
P-60  
C-47  
P-59  
C-48  
P-58  
C-49  
P-57  
C-50  
P-56  
C-51

12.56

1-31



1030  
 1036  
 1044  
 1049  
 1056  
  
 1076  
 1076  
 1070  
 1069  
 1069  
 1068  
 1062  
 1062  
 1053  
 1030  
 1013  
 1008  
 1002  
 1001  
 991  
 990  
 985  
 979  
 977  
 977  
 976  
 968  
 954  
 943  
 938  
 938

-062  
 V.C.  
 -1.32  
 V.C.  
  
 -0.89  
 V.C.  
 +0.01  
 V.C.  
 0.0  
 V.C.  
 +0.29  
  
 +0.43  
  
 +0.64  
  
 +0.86  
 V.C.  
 +0.18  
  
 V.C.  
 +0.38  
 V.C.  
 +0.73  
 +0.80  
 V.C.  
 0.0  
 V.C.  
 V.C.  
 +1.2  
 +1.4  
 +1.0  
 0.0

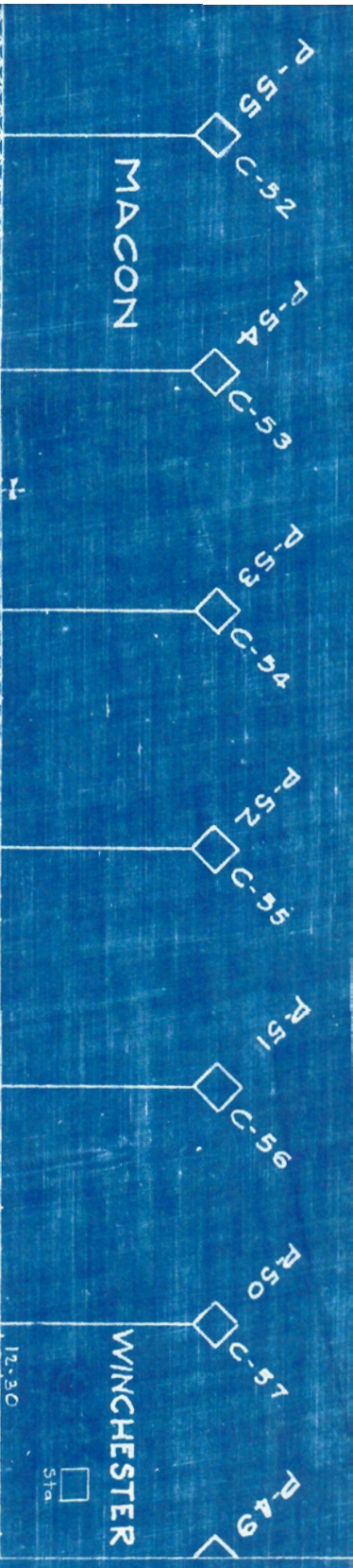
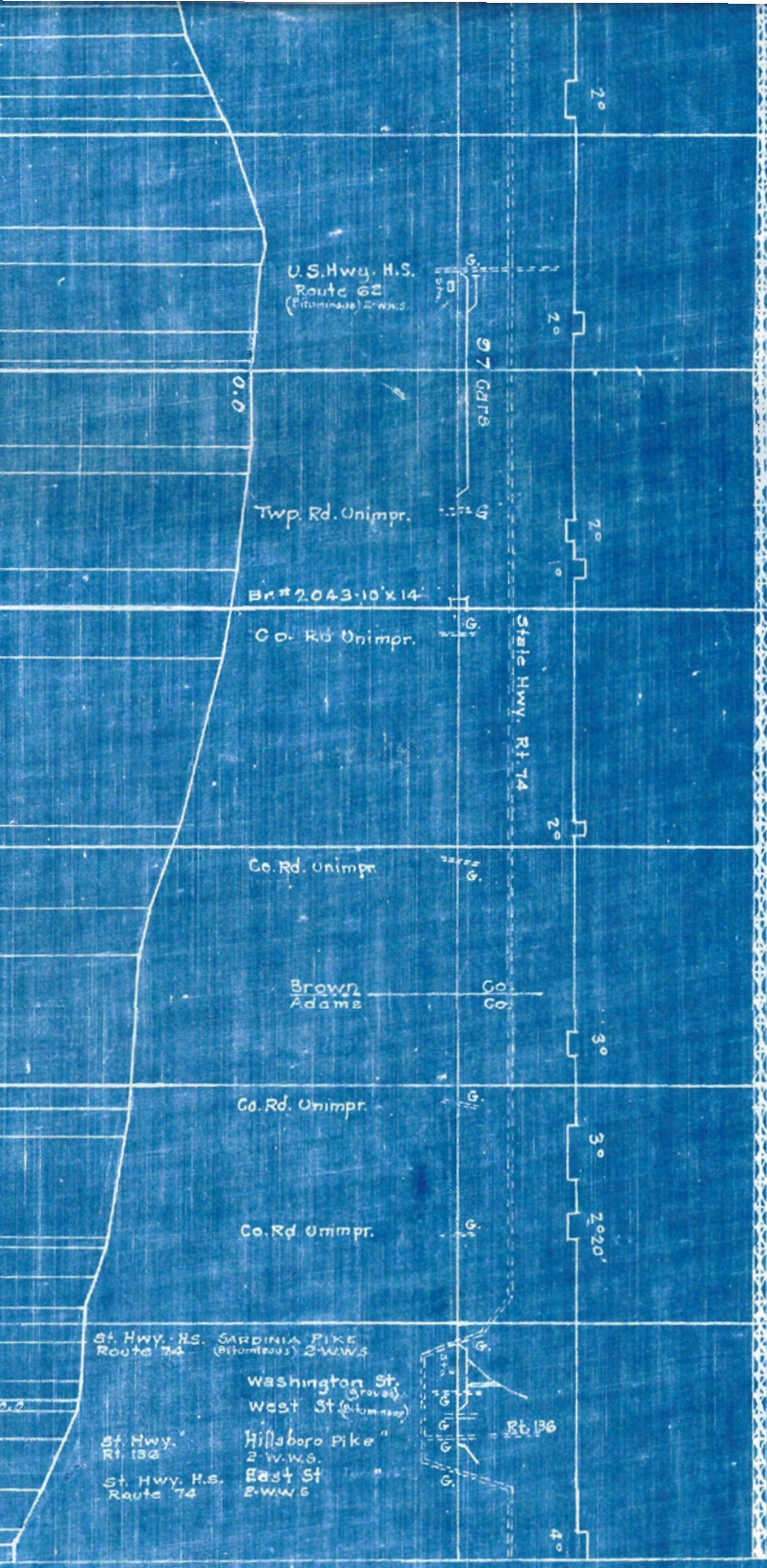



938	00
934	+0.428
924	+0.76
916	+1.0
913	+0.5
913	00
914	V.C.

938	-1.04
941	V.C.
941	0.0
942	V.C.

945	-0.25
952	V.C.
954	V.C.
955	-0.2
955	0.0
954	V.C.
954	0.3
953	V.C.
953	-0.2
951	V.C.
948	+1.03
941	+1.1

926	+1.16
915	+1.57
908	+1.078
902	+0.618

851	+1.25
-----	-------

815	+1.35
789	+1.23

759	+1.278
-----	--------

705	+1.415
-----	--------

678	+1.59
674	+0.8
673	+0.253
670	+0.556

655	+1.305
654	V.C.
653	V.C.
651	+0.95
651	0.0
650	V.C.
646	+1.333
644	V.C.

639	+0.241
637	V.C.
629	+1.214
625	+0.822

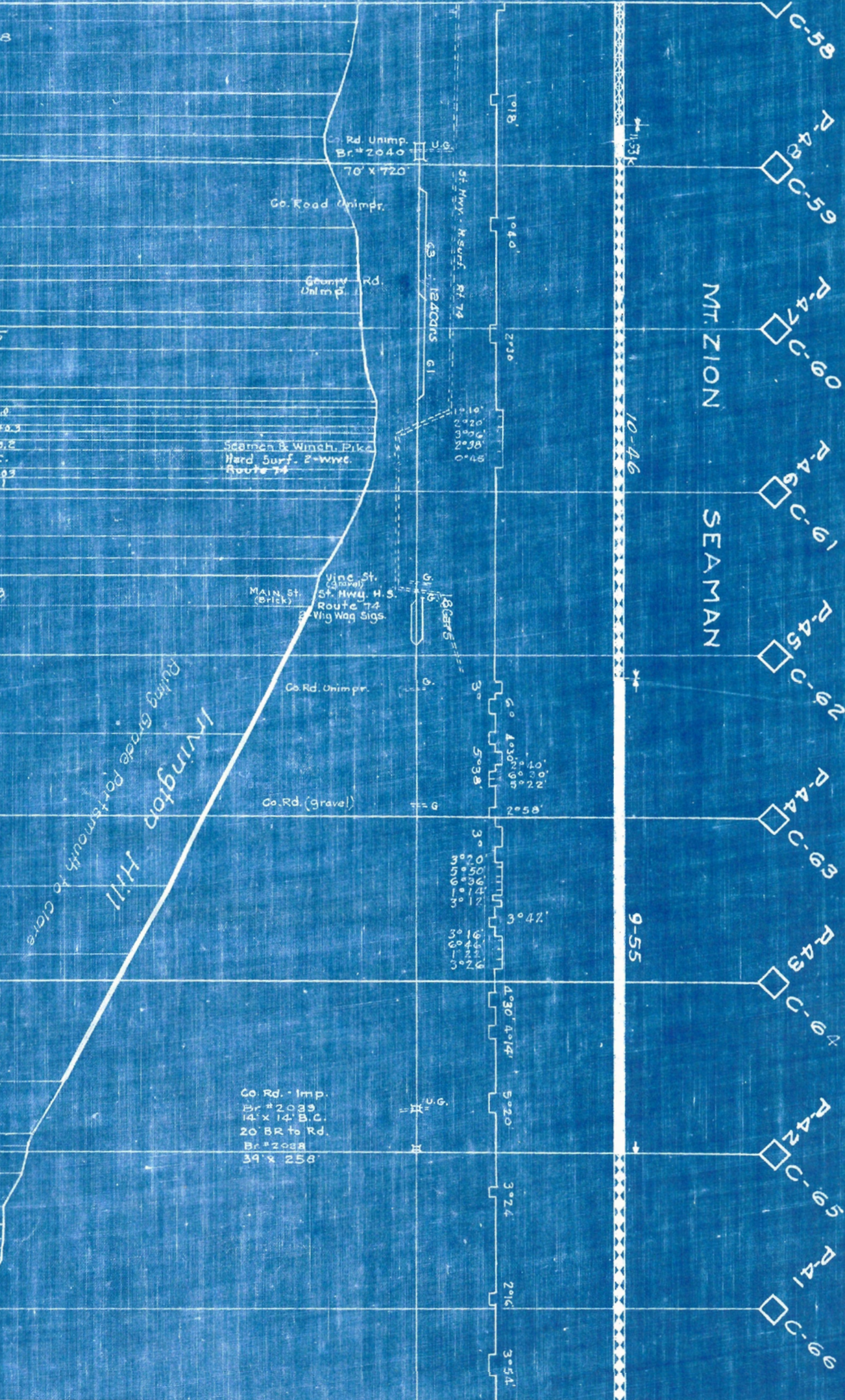



625	+0.822
625	0.0
629	V.C.
626	-1.723
646	V.C.
636	+1.18
637	+0.9907
634	0.0
636	V.C.
641	-1.31
649	-0.566
647	V.C.
644	+0.755
643	0.0
643	V.C.
632	+1.125
625	+0.636
622	+0.228
622	0.0
623	V.C.
629	-0.988
630	V.C.
629	-0.125
631	V.C.

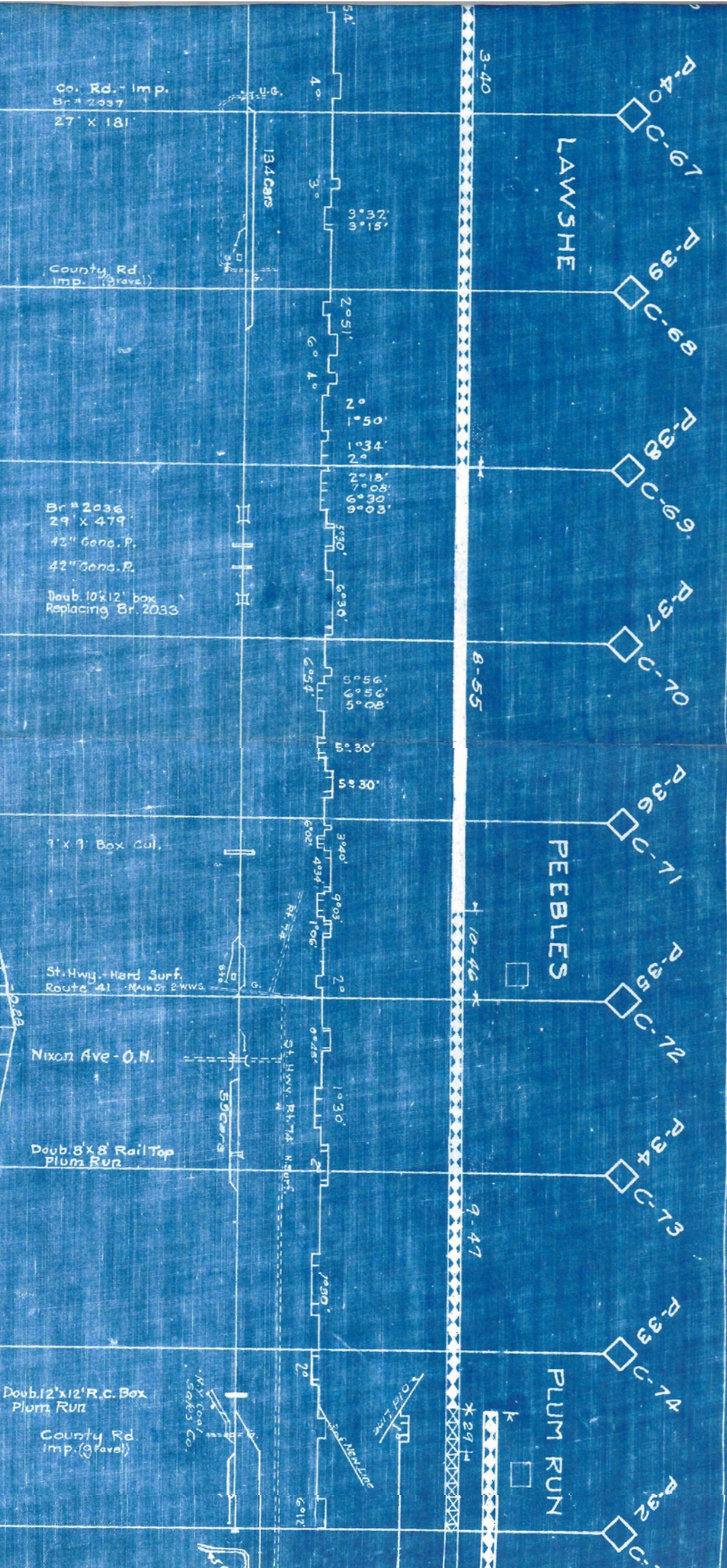
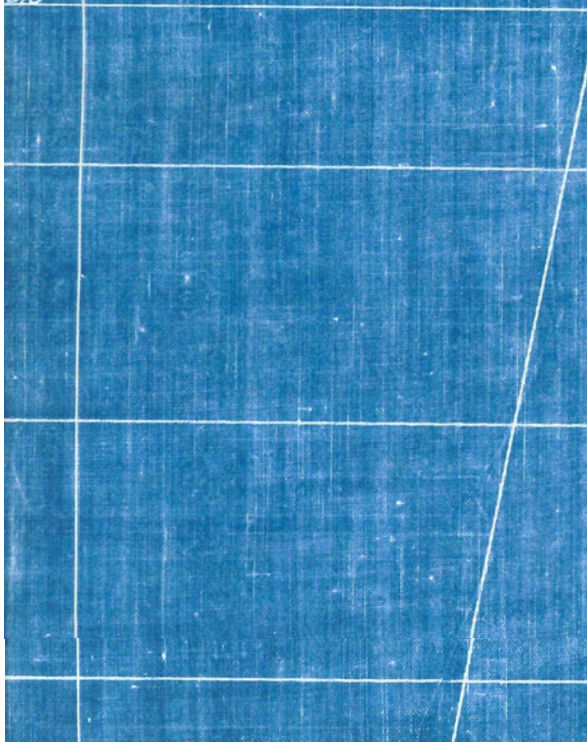
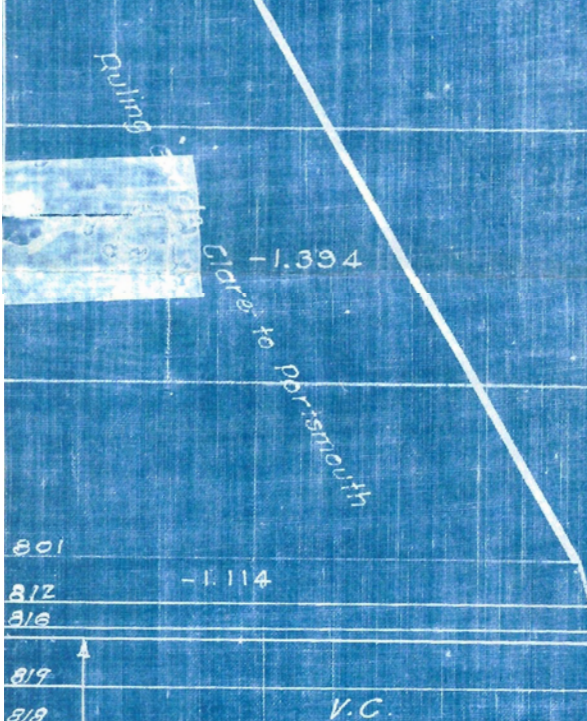



FROM PROFILE #1231-G  
ELEV 500'

Br. 2024-C (Viaduct)  
63' BR TO W.S. L=705'-8"

0.5% GRADE  
NEW LINE

County Rd. Imp  
(Gravel)  
Br. # 2024-B  
30' x 36'  
Scioto Brush Creek

Br. # 2023  
Rail Top Cul.  
6' BR TO GR.

Br. 2022  
Duo. 8' Rail Top.  
6' BR TO GR.

Pri. Rd.  
13 x 146'  
Br. # 2021

6' x 37'  
Br. # 2019  
Co. Rd. Imp.  
(Gravel)

ST. HWY. Rt. 73 Hard Surface  
Shelter  
Brid.

MINERAL SPRINGS

RARDEN

630	
622	V.C.
622	+0.08
622	+0.09
619	+0.50
	From Profile #12035
619	0.0
615	+0.20
615	0.0
615	+0.20
613	0.0
613	+0.20
613	0.0
613	+0.10

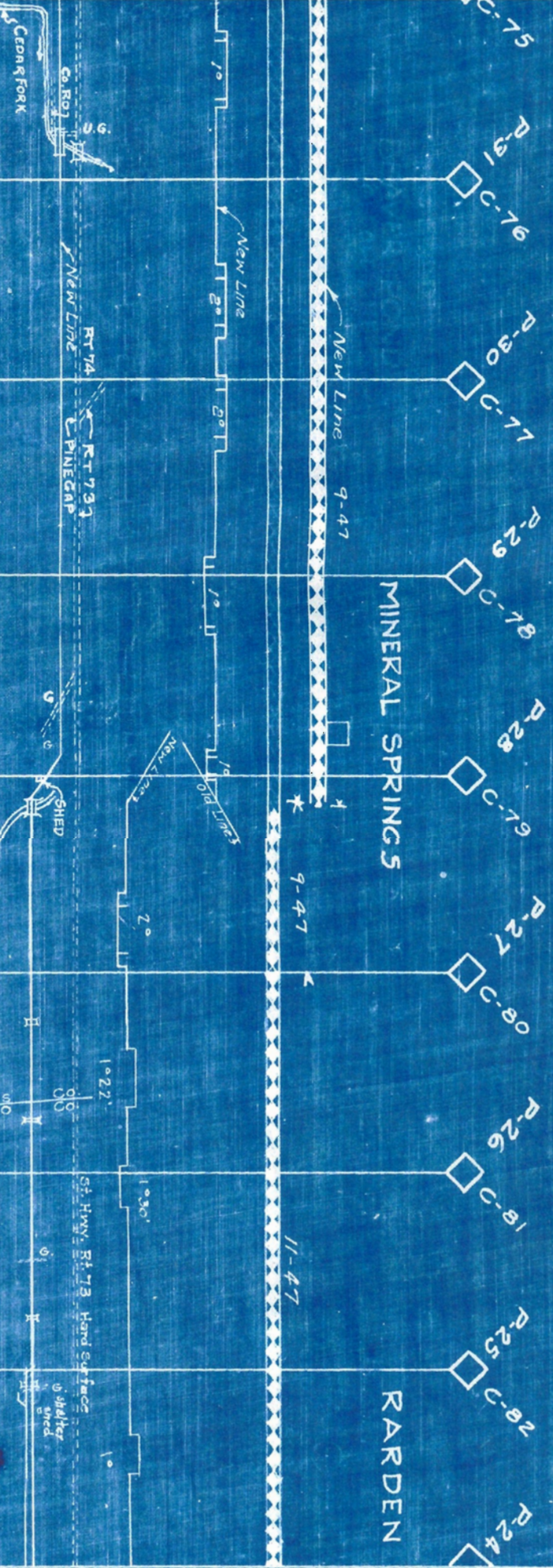

C-75  
R-31  
C-76  
R-30  
C-77  
R-29  
C-78  
R-28  
C-79  
R-27  
C-80  
R-26  
C-81  
R-25  
C-82  
R-24



609		+0.10
609	0.0	
609	+0.46	
604		-0.10
605		
605	0.0	
604	+0.222	
	+0.544	
597		+0.139
591		
591	0.0	
593	-0.5	
593	0.0	
593	+0.375	
591	0.0	
591		
596	-0.474	
596	0.0	
590	+0.5	
590	0.0	
593	-0.45	
593	0.0	
588	+0.476	
588	0.0	
588	-0.156	
589	0.0	
589	+0.32	
586	0.0	
586	-0.182	
587	0.0	
584	+0.318	
584	0.0	
584		
590	-0.305	
585	VC	
585	+1.021	
583	+0.4	
583	0.0	
584	-0.66	
584	0.0	
585	+0.45	
585	0.0	
589	+0.615	
589	0.0	
588	VC	
577	+0.853	
577		
580		
580	-0.675	
580	VC	
575	+0.227	
575		
571	+0.308	

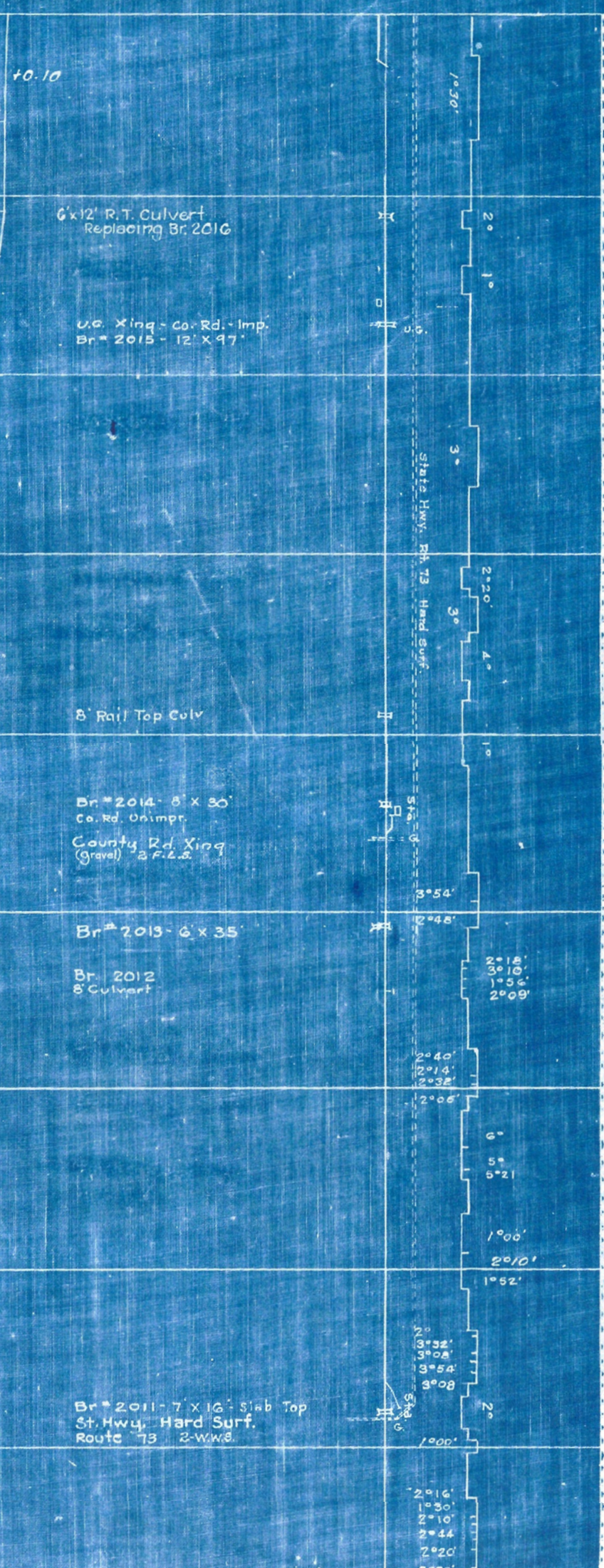



575	
571	+0.308
571	0.0
572	V.C.
573	-0.812
578	-0.333
578	-0.027
578	V.C.
580	
574	+0.65
574	V.C.
573	
587	-0.457
587	0.0
587	+0.239
587	0.0
589	-0.5
589	V.C.
582	+0.872
580	+0.26
580	0.0
580	-0.295
583	-0.044
583	0.0
583	+0.0773
582	+0.183
579	0.0
578	V.C.
573	+0.612
574	V.C.
578	-0.528
576	0.0
575	+0.247
575	0.0
580	-0.5
579	V.C.
576	+0.7
570	+0.30
570	0.0
570	+0.46
559	
553	+0.20
542	+0.90
542	0.0
542	+0.331
538.9	800' V.C.

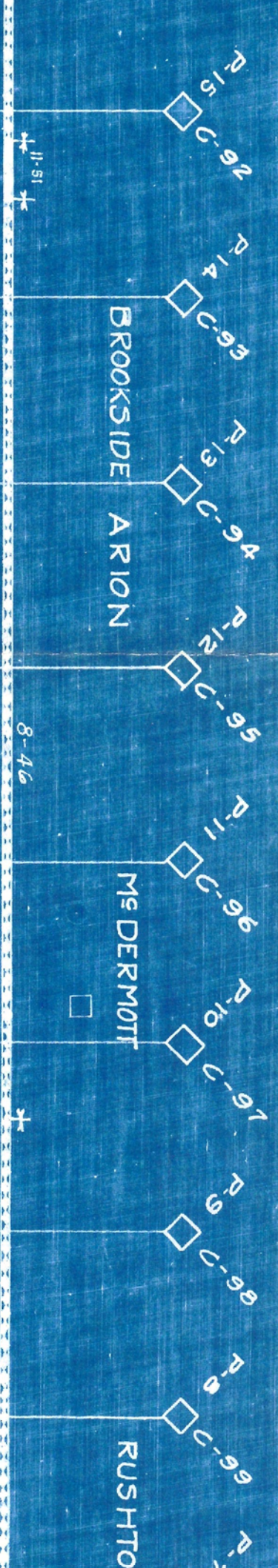
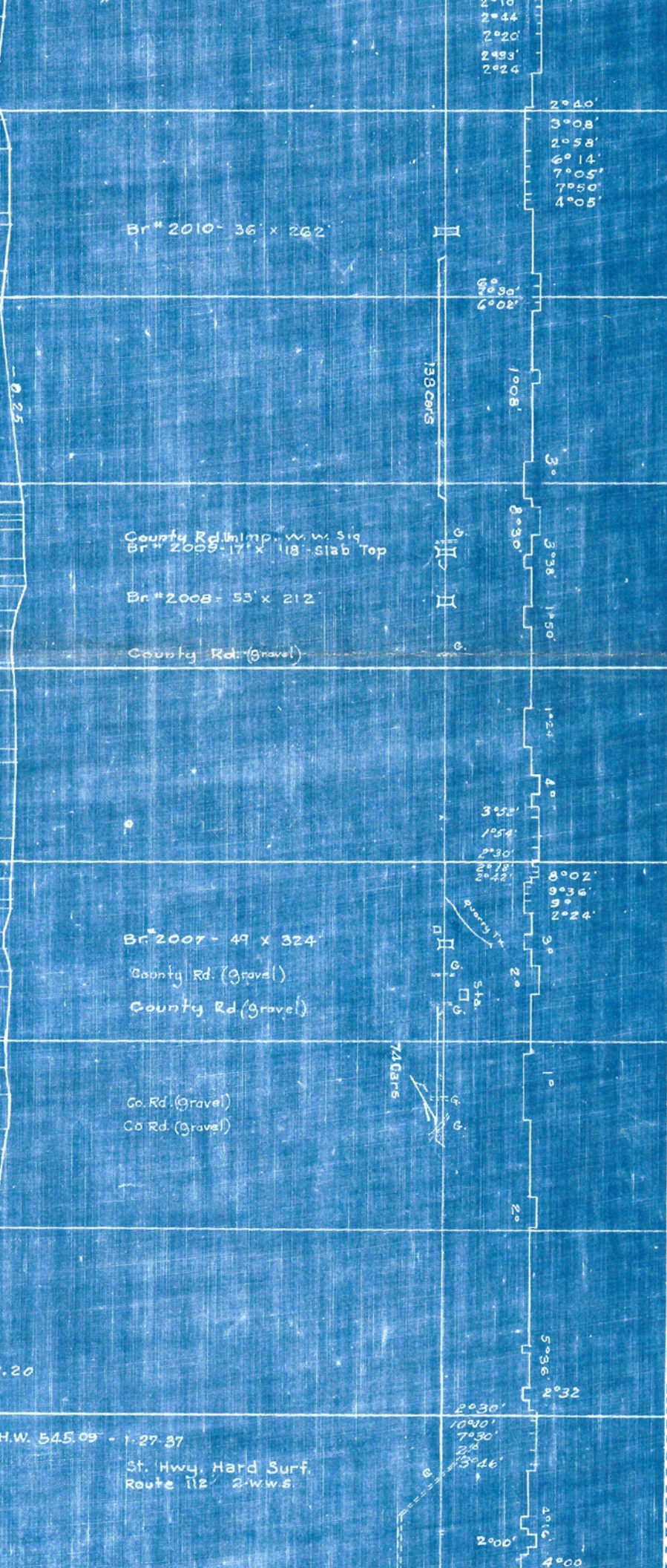

SEE  
CHINA



ELEV 400

EN-7500 SHAG FOR FLOOD DATA ON  
10, SCIOTO & LIT. MIAMI RIVERS

PROFILE #12548-B  
#12548-C

0.0

H.W. 545.02 - 1-27-37

H.W. 544.9  
1-27-37

NOTE :-

0.0 Portsmouth Ohio River Gauge = E.I. 470.97 N. & W. Datum  
H.W. Jan. 27, 1937 Stage 74.05 = E.I. 545.02

533.9	
534.4	-0.4±
534.9	+0.045±
534.9	0.0
534.1	-0.02±
537.1	-0.41±
541.0	-0.56±
638.0	+0.214
539.0	-0.10
534.4	+0.30
534.1	+0.014
534.2	0.0
536.2	-0.22
537.7	-0.08

2002 Br. 2001

H.W. 545.02  
1-27-37

High Water - 1-27-37

See Profile #12804

Br #2002 - 33' x 133'  
Brush Ck.

Br #2001 - 39' x 2164'  
Scioto R.

Br #1066 - 16' x 22'  
Br #1065 - 16' Stb. Arch

21' B.R. to Gr.  
Bartha Ave Gr. (Cinders)  
B-WWS.

Spring Lane Gr. B-WWS.  
(Broken Gravelers)

Turntable

H.W. 545.02  
1-27-37

Chillicothe St.  
(Asphalt)

Chillicothe St

14 St. Brk. (Bell)  
13 St. Brk.  
12<sup>TH</sup> ST. PAVED - R. 27 SIG - TIM. Gd. RES  
11 St. Brk.  
10 St. Asphalt  
Finley St.  
John St. Brk.  
Walker St. (Xing Watchmen)  
OFFNER St. CIG.

16<sup>TH</sup> St. UG  
15<sup>TH</sup> St. Brk. 2 WWS  
14<sup>TH</sup> St. " " 2 WWS  
13<sup>TH</sup> St. " " 2 WWS  
12<sup>TH</sup> St. " " "  
11<sup>TH</sup> St. Asphalt "

Offner St. ug.

Lincoln St. (Xing Watchmen)

Lincoln St. Brk.

Hutchins (Brick)

Hutchins St. (Brick)



9-46

50,000 gal.  
WT

F.A.T. ○  
20,000 gal. STEEL

BOOK

VERA

PORTSMOUTH

100  
P-9  
C-101  
P-5  
C-102  
P-4  
C-103  
P-3  
C-104  
P-2  
C-105  
7608  
Col-99  
1607  
Col-100  
N-606

10330-1