

63

150 lb
125 lb
100 lb
75 lb
50 lb
25 lb
100 lb
100 lb

Bill A-57
Bolt or Cotter Pin
Ground
Cotter or Washers
Sleeve

Alerts appear on following

SYMBOLS

	Depot	---	■
	Flakerm	---	□
	Tank	---	○
	Water Tank	---	●
	Water Column	---	⊕
	Turntable	---	⊖
	Trench	---	□
	Scale	---	□
	Casting Stand	---	□
	Wagon	---	□
	Roller	---	□
	Roll Road Crossing	---	□
	Rolling Undergrade	---	□
	Roll Crossing Overhead	---	□

BALTIMORE AND OHIO SYSTEM WESTERN REGION TOLEDO INDIANAPOLIS DIVISION INDICATING TOLEDO

Work Report, Assignment & Profile
Created Feb. 1952
Office of Chief Engineer
Baltimore Md.

Bal

Ballast

Rail

Curve 300

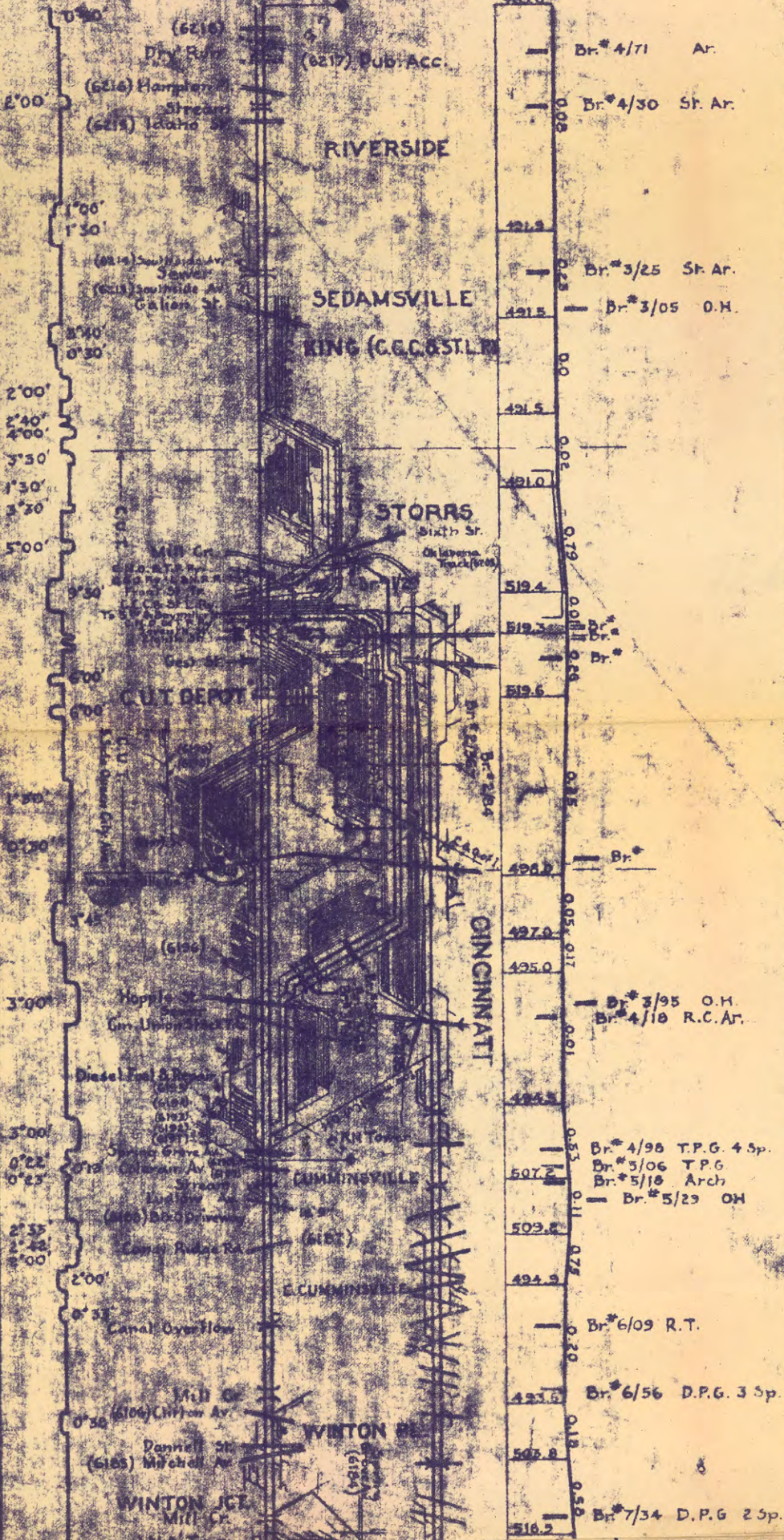

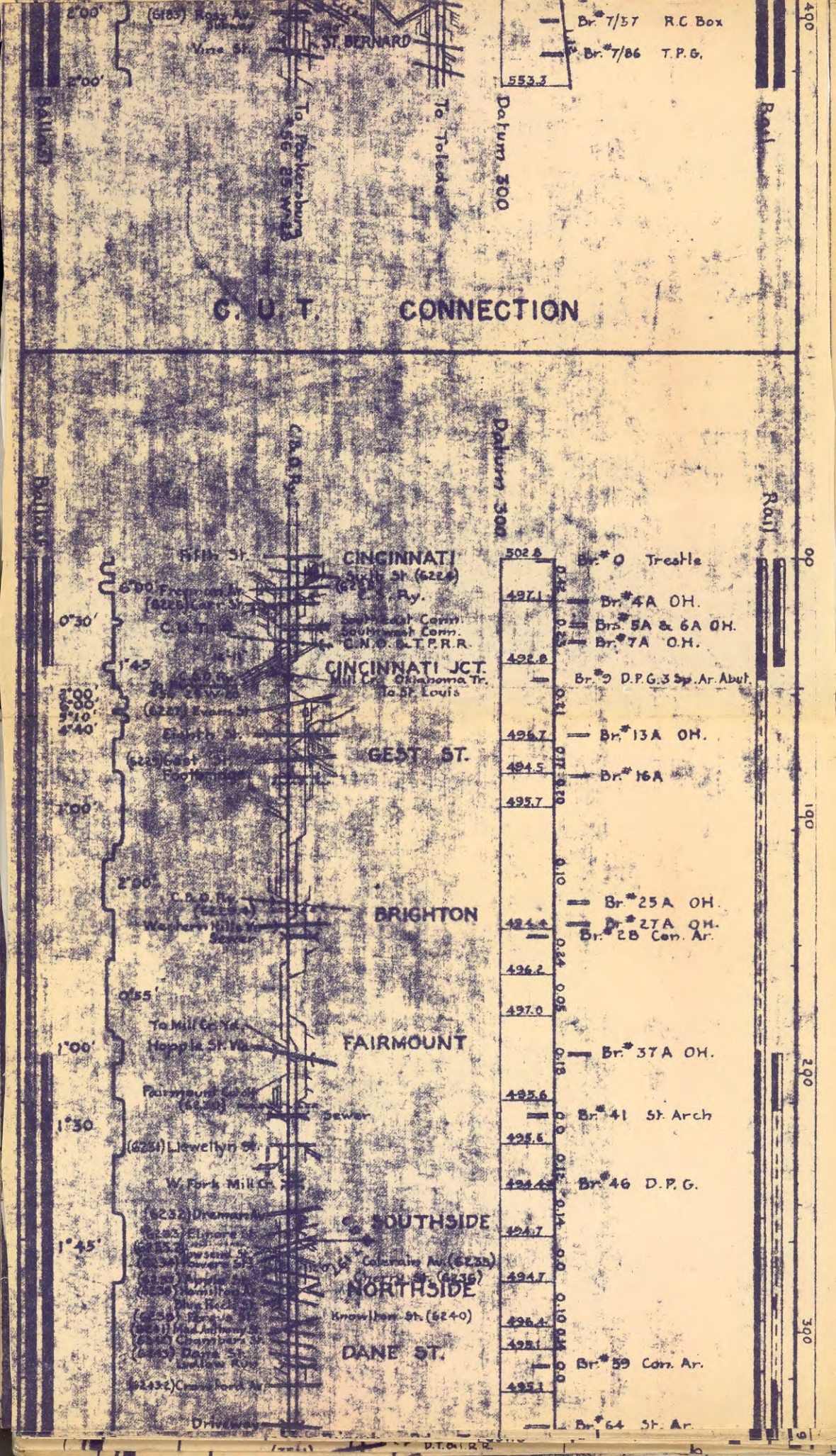

C. O. T. CONNECTION

Br.* 7/37 R.C. Box
 Br.* 7/86 T.P.G.
 553.3
 Datum 300

Elevation	Structure
502.8	Br.* 0 Trestle
497.1	Br.* 4A OH.
492.8	Br.* 5A & 6A OH.
	Br.* 7A OH.
	Br.* 9 D.P.G. 3 Sp. Ar. Abut.
496.7	Br.* 13A OH.
494.5	Br.* 16A
493.7	
	Br.* 25A OH.
494.4	Br.* 27A OH.
	Br.* 2B Con. Ar.
496.2	
497.0	
	Br.* 37A OH.
495.6	
	Br.* 41 St. Arch
495.5	
494.4	Br.* 46 D.P.G.
494.7	
494.7	
496.4	
498.1	
	Br.* 59 Con. Ar.
495.1	
	Br.* 64 St. Ar.

CINCINNATI
 C.A. & S. Ry.
 C.O. & N. Ry.
 Southeast Conn.
 Southwest Conn.
 C.O. & T.P.R.R.

CINCINNATI JCT.
 Mill Cr. Okinoma Tr.
 To St. Louis

BRIGHTON

FAIRMOUNT

SOUTHSIDE

NORTHSIDE

DANE ST.

2'00'
 2'00'
 0'30'
 1'45'
 3'00'
 6'30'
 5'10'
 4'40'
 3'00'
 2'00'
 0'55'
 1'00'
 1'30'
 1'45'

490
 190
 290
 300

(6185) Ross Av. Subway
 (6225) Car St.
 (6227) Evans St.
 (6231) East St.
 (6232) Dreamland
 (6233) Elmore St.
 (6234) Howard St.
 (6235) Lawrence St.
 (6236) Myrtle St.
 (6237) North St.
 (6238) Park St.
 (6239) Madison St.
 (6240) Dan St.
 (6241) Crane Park St.

Galvanic Ar. (6235)
 Cherry St. (6236)
 Knowlton St. (6240)

(6240) Winton Pl
(6243) Station Ar

WINTON PL

(6244) Mitchell Ar

WINTON JCT.

(6247) ...
(6248) Eds Ar

IVORYDALE

Mill Cr
(6249) Junie St

ELMWOOD PL.

(6250) Center Mill Ar

STEELETON
CARTHAGE

(6251) 71st St
(6252) 74th St

RENSSELAER

Carters Pl
(6253) ...

HARTWELL

Hartwell Ar
(6254) Sheehan Ar
(6255) Milldale Ar

MAPLEWOOD

(6259) Cooper Ar
(6260) ...
(6261) Wyoming Ar

WYOMING-LOCKLAND

(6262) Mulberry St
Mill Cr

PARK PLACE

1°00'

WOODLAWN

(6263) ...
Sewer

GLENDALE

(6264) ...
Skinner Ar
(6265) Oak St

GLENDALE

(6266) ...
Glendale Rd
(6267) ...

GLENDALE

(6268) ...
0°30'
0°00'
0°30'
1°20'

GLENDALE

(6269) ...
0°45'

0°45'

US 21 50.5 by Pass
Carrington Cr

504.0
504.9
509.3
513.0
522.6
524.9
538.0
543.6
552.4
568.2
578.5
594.3
606.8
624.6
630.8
643.6
659.6
657.9

Br. #75 Con. M.
Br. #76 D.P.G. 4 Sp.

Br. #83 Con. Arch

Br. #100 D.P.G. 2 Sp.

Br. #103 T.P.G. 3 Sp.

Br. #108 T.P.G. 3 Sp.

Br. #123-25p. Con. Ar.

Br. #133 St. Ar.

Br. #138 Con. Ar.

Br. #140 C.M.

Br. #152 St. Ar.

Br. 161A-O.H.

Br. 167A, O.H. Hwy
Br. #168 C.Box

400
500
600
700
800

OHIO-NEWARK DIV. TOLEDO-II

1'00" (7300) **CRESTVUE**
 Crescent Hill Rd.
 Hamilton Co.
 Butler Co.

INDIANAPOLIS DIV.

(7502) **MUHLHAUSER**
 Muhlhauser Rd.
 (7503) **STOCKTON**
 Seward Rd.



(7304) **FAIRSMITH**
 Gilmore Rd.
 (7305) **SCHENCK**
 Symmes Av.

Hamilton Pike
 (45) S.R. 4

(7306) **LINDENWALD**
 Laurel Av.
 (7307) Belle Av.
 (7308) **S. HAMILTON**
 Central Av.

Diesel Fuel
 (7309) **HAMILTON**
 (7310) Walnut St.
 (7311) Tiffin St.
 (7312) E. Ludlow St.
 (7313) Maple Av.
 (7314) Butler St.
 (7314) High St. (7316)
 Dayton St. (7316)

(7319) **OLD RIVER JCT**
 (7320) Verde St.
 Old River

672.6	0.38	
674.9	0.28	
678.4	0.20	
679.9	0.08	Br. #186 R.T.
673.0	0.15	
668.7	0.25	
662.2	0.35	Br. #197 C.M.
	0.39	Br. #133A OH Hwy Br. #200 72" CLUV
645.2	0.39	Br. #204 D.P.G.
639.9	0.30	
	0.35	
621.3	0.45	
614.4	0.09	
612.1	0.03	Br. #228 T.P.G. 3Sp.
612.6	0.02	Br. #232 D.P.G.
608.2	0.12	
605.9	0.17	
	0.09	
597.2	0.00	
595.5	0.00	
	0.25	Br. #258 St. Arch.
592.1	0.11	
594.2	0.20	Br. #266 4Sp. St. Ar.
593.6	0.09	
	0.09	
597.3	0.00	

1000
1100
1200
1300
1400

0'50"
3'00"
1'00"

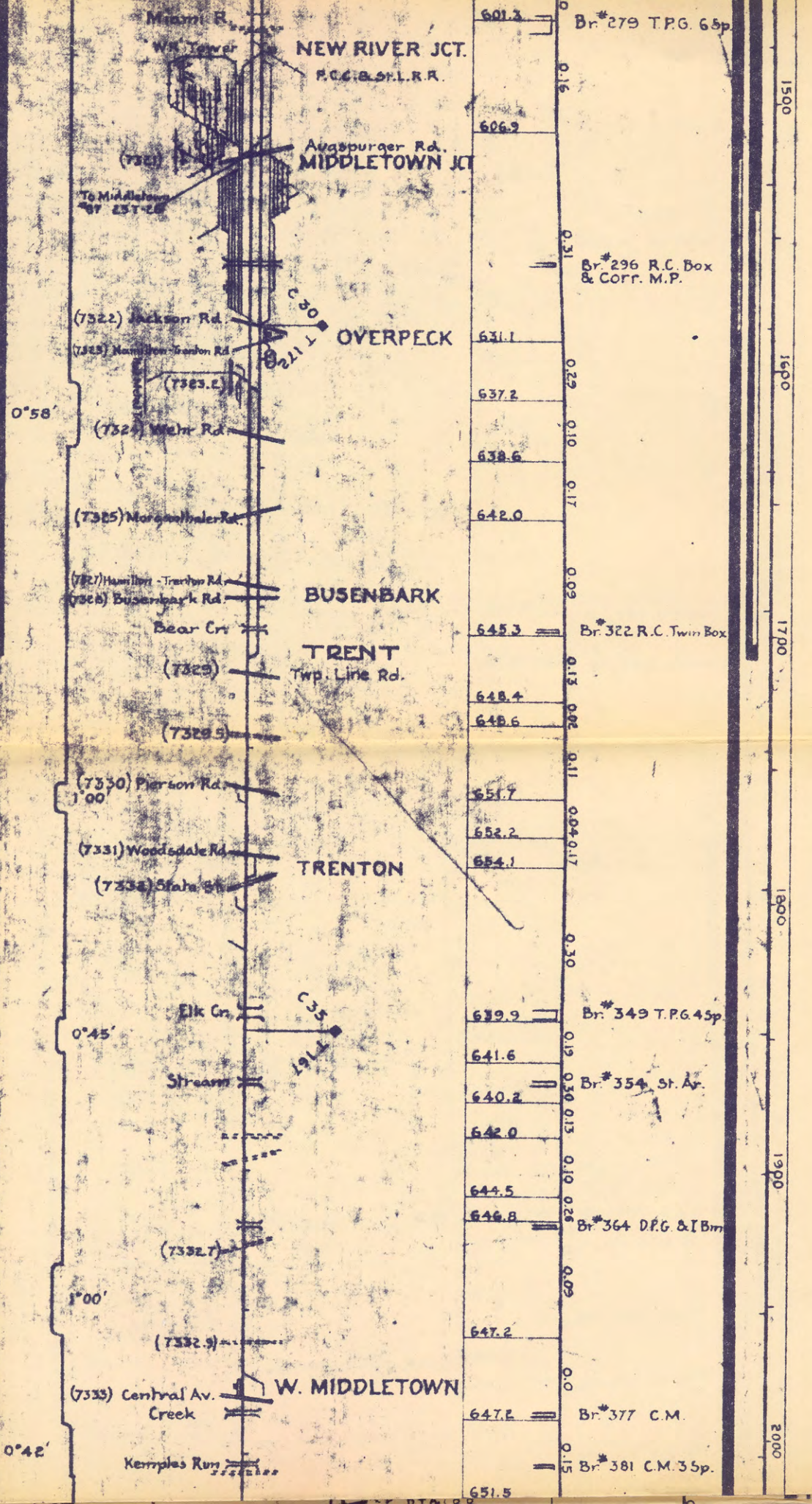

NEW RIVER JCT.

P.C. & S.P.L.R.R.

MIDDLETOWN JCT.

OVERPECK

BUSENBARK

TRENT
Twp. Line Rd.

TRENTON

W. MIDDLETOWN

Br. #279 T.P.G. 65p

Br. #296 R.C. Box
& Corr. M.P.

Br. #322 R.C. Twin Box

Br. #349 T.P.G. 45p

Br. #354 St. Ar.

Br. #364 D.P.G. & I.B.M.

Br. #377 C.M.

Br. #381 C.M. 35p.

1500
1600
1700
1800
1900
2000

0°58'

1°00'

0°45'

0°42'

601.3
606.9
631.1
637.2
638.6
642.0
645.3
648.4
648.6
651.7
652.2
654.1
639.9
641.6
640.2
642.0
644.5
646.8
647.2
647.2
647.2
651.5

C 30
1911

C 35
1911

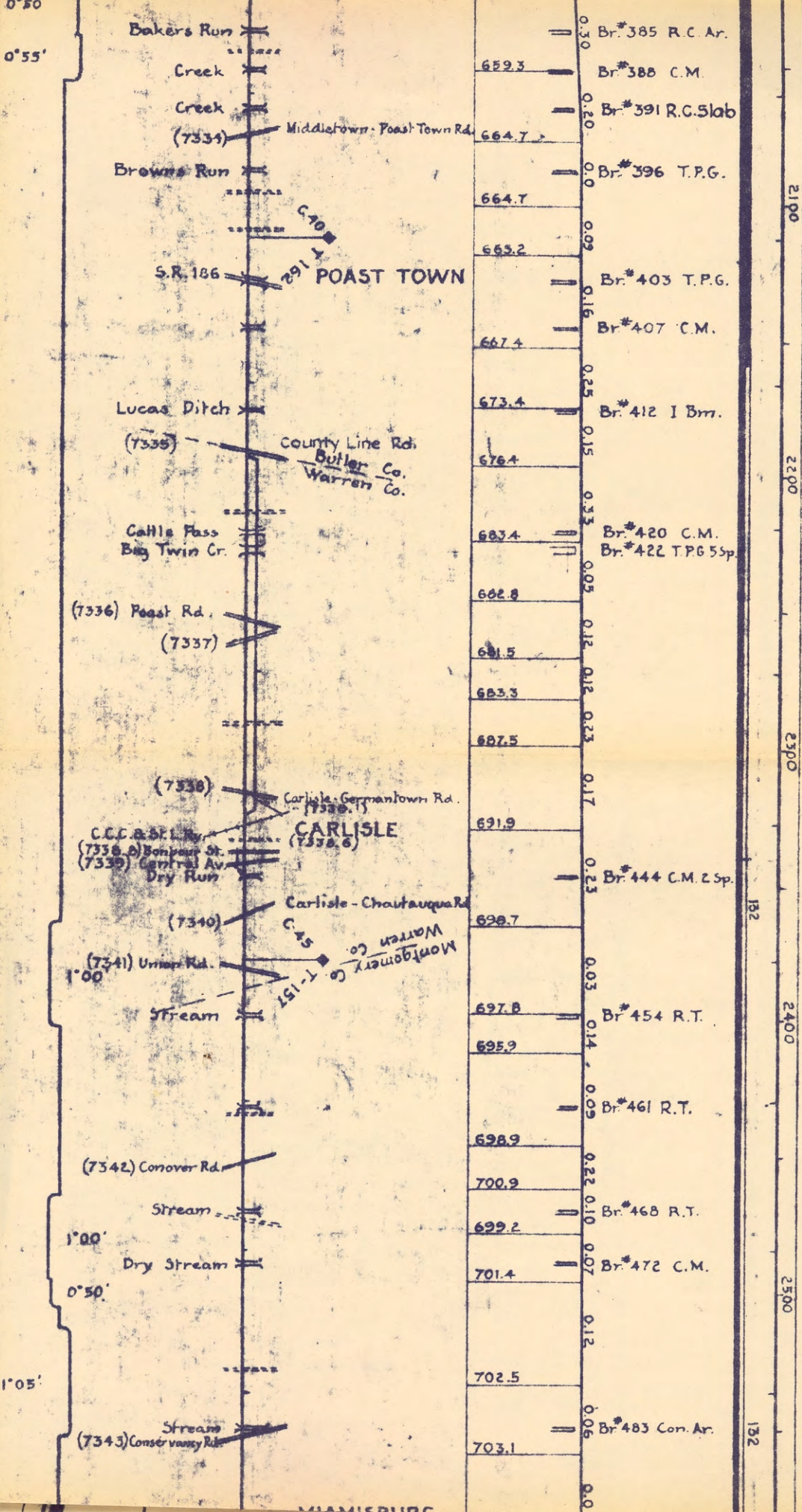

0°50'

0°55'

1°00'

0°50'

1°05'

2100

2200

2300

2400

2500

(7345) Linden St. (7345.8) River View Rd. (7345.9) Germantown Rd.

(7346) Germantown Rd. S.R. 725

Bear Cr. (7347) Upper River Rd. C 50

0°30'

(7348) Summersville Rd. WHITEFIELD

Opossum Run

Stream

Stream

(7349) Apple Rd. 1°30'

Stream

"SD" CABIN C 55

Stream

(7350) W. River Rd. 1°00'

1°00'

1°00'

(7351) Nicholas Rd. "WF" CABIN

(7352) Miami Chapel Rd. Weaver St. (7353)

(7358) Broadway S. DAYTON
(7359) Bolander Av. Hillwater Jct. #67, 25T-26

CCC&N.R. To Union City #68, 25Q-31

(7260) Washington St. Louisa St. MIAMI CITY JCT.

Great Miami R. P.R.R. Longworth St. DAYTON UNION STA

Ludlow St. S. Main St. Patterson Blvd. Jefferson St.

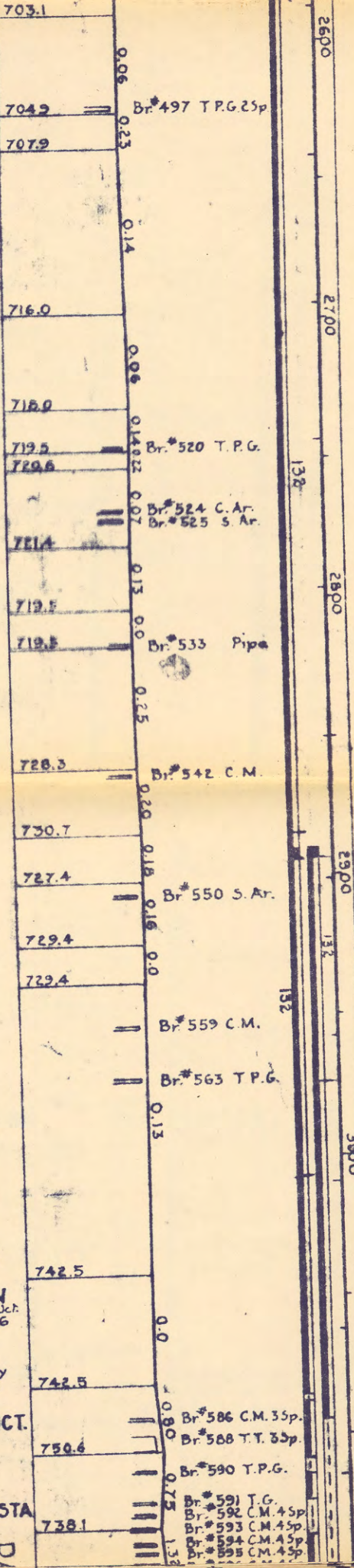

1°30'
2°30'
2°19'

2600
2700
2800
2900
3000
3100

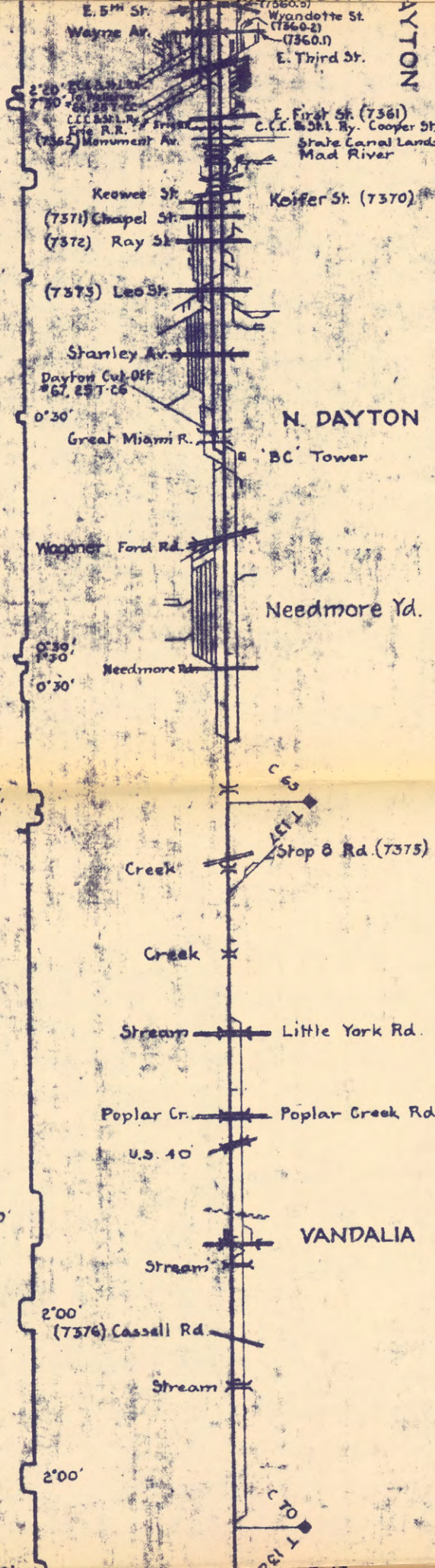

747.0	0.57	Br.*598 C.M. 5Sp.
744.1	0.57	Br.*600 C.M. 5Sp.
746.1	0.57	
742.4	0.75	Br.*608 C.M. 22Sp.
750.0	0.75	Br.*605 C.M.
	0.75	Br.*606 T.P.G. 5Sp.
745.2	0.75	Br.*607 R.T.
744.9	0.75	Br.*608 T.P.G. 3Sp.
	0.75	Br.*608A O.H. Hwy.
753.9	0.30	
757.0	0.15	Br.*619A OH
757.0	0.05	
757.0	0.0	Br.*625 T.P.G. 5Sp.
772.1	0.48	Br.*632A OH
778.1	0.17	Br.*641A OH Hwy.
778.1	0.0	
776.0	0.17	Br.*650 C. Ar.
770.4	0.30	Br.*655 C. Ar.
773.0	0.19	
773.0	0.0	Br.*661 C. Ar.
777.0	0.27	
775.2	0.26	Br.*666 C. Ar.
778.7	0.26	
781.0	0.15	Br.*672 C. Ar.
	0.15	Br.*673 CM 35p
790.4	0.81	Br.*681A OH
	0.81	Br.*682 C. Ar.
801.7	0.17	Br.*690 C. Ar.
803.4	0.17	
803.6	0.31	
806.9	0.01	
	0.80	

3200
3300
3400
3500
3600
3700

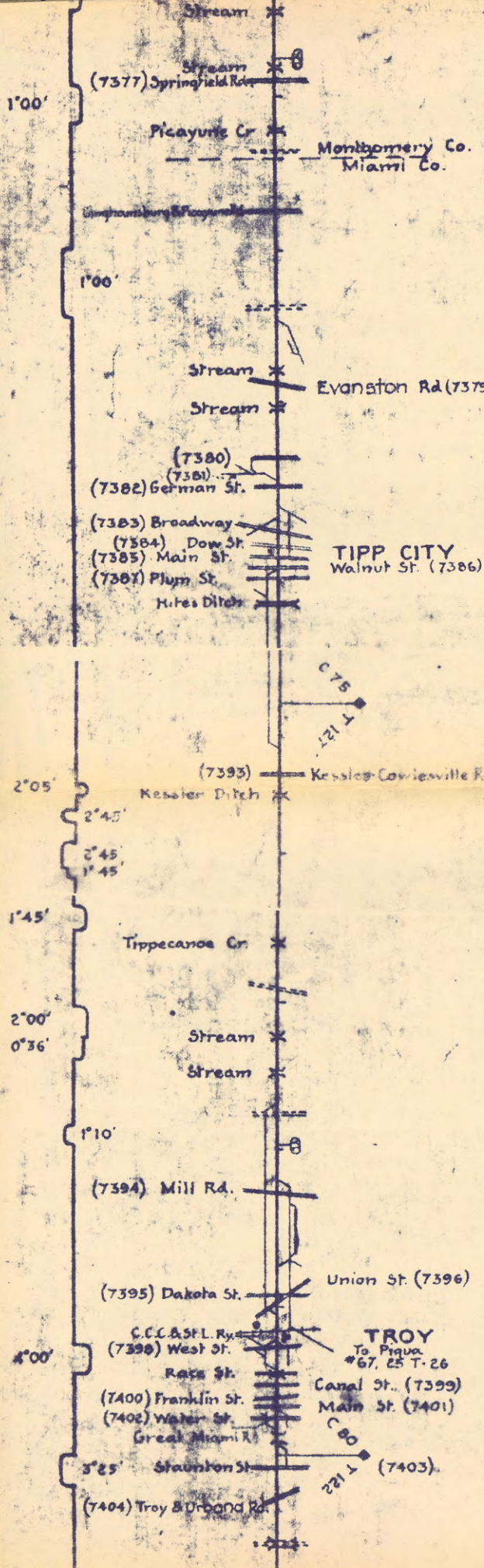

805.2	0.13	Br.*704 C.Ar.
	0.44	Br.*708 C.Ar.
793.6		Br.*712 C.Ar.
	0.37	
805.0		
812.9	0.48	
822.5	0.65	
822.2	0.03	
819.7	0.03	Br.*728 S.Ar.
	0.45	Br.*730 S.Ar.
829.4		
	0.05	
831.1	0.21	
833.5		Br.*743 R.T.
	0.32	
844.0		
	0.50	
828.7	0.15	Br.*756 C.Ar.
820.6	0.02	
820.2	0.30	Br.*766 D.P.G.
818.3	0.01	
818.6	0.19	Br.*774 D.P.G.
818.5	0.0	Br.*775 D.P.G.
818.5	0.14	
820.4	0.32	
833.2	0.08	
835.5	0.35	Br.*795 D.P.G.
839.0	0.01	
834.9	0.01	
834.8	0.30	Br.*799 T. 695p.
839.0	0.12	Br.*806 I.Dm.
842.2		

TROY
 To Piqua
 #67, 25 T-26
 Canal St. (7399)
 Main St. (7401)

Co. Infirmary Lane (7404.1)
"GR" CABIN

Spring Cr. Troy & Sidney Rd.

Cattle Pass (7406) Troy & Piqua Rd.
(7405)

Cattle Pass
Reinhard Ditch
(7407) Rusk Rd.
(7408) Orbison Rd.

(7409) Peterson Rd.

Shroyer Ditch

(7410) U.S. # 25
Loy Rd. Gorley Ditch

(7411) Statler Rd.

P.C. & S.L.R.R. NA Tower
(7412) E. Moore St. Piqua Xing

SR # 36
Gorbry Ditch

US 28
(7413) Dixie Highway

Cattle Pass

Brush Cr.

Miami Shelby Rd.

Stream

843.6

849.7

880.6

885.1

898.5

899.6

901.2

904.2

910.5

911.0

909.7

901.3

920.6

920.6

932.1

941.7

939.1

952.0

961.7

961.9

0.06
0.32
0.45
0.69
0.41
0.06
0.20
0.07
0.15
0.04
0.03
0.35
0.80
0.06
0.49
0.28
0.16
0.49
0.40
0.01

Br #820 D.P.G. 3 Sp.
Br #821 T.P.G.

Br #824 C.M.

Br #833 C.M.
Br #834 C.Ar.

Br #852 Tw. C.B.

Br #855A
Br #856 Pipes

Br #873 C.Ar.

Br #876 UB
Br #878 S.Ar.

Br #886A

Br #892 I Brm.

Br #900 D.P.G. & I. Brm.

Br #909A OH.

Br #915 C.M.

4300
4400
4600
4700
4800

0'40'
5'00'
2'15'

U.S. # 25
T 117

(7411)
(7412)
(7413)

U.S. # 28
T 112

Shelby Co.
Miami Co.

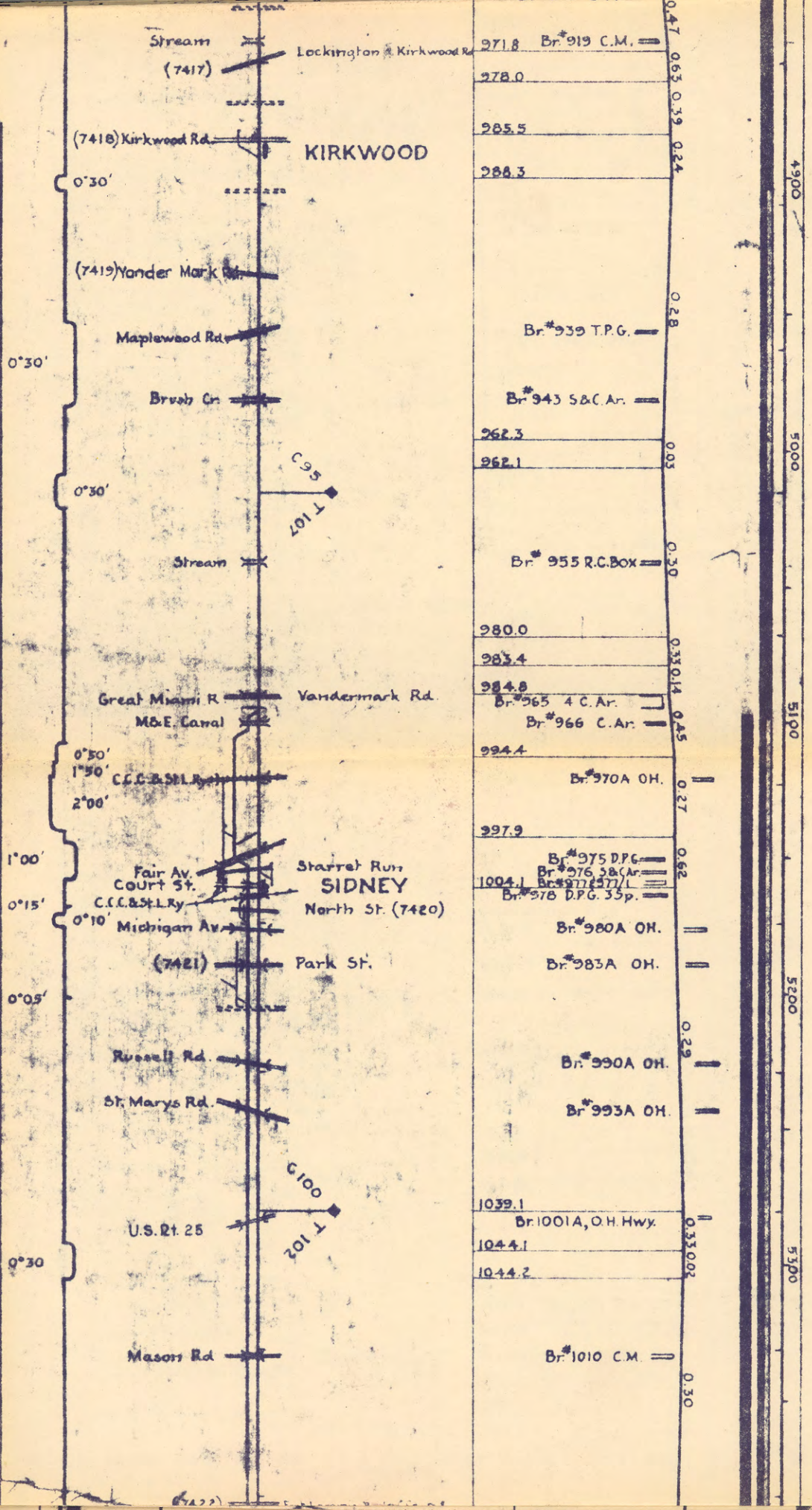

C 95
T 107

G 100
T 102

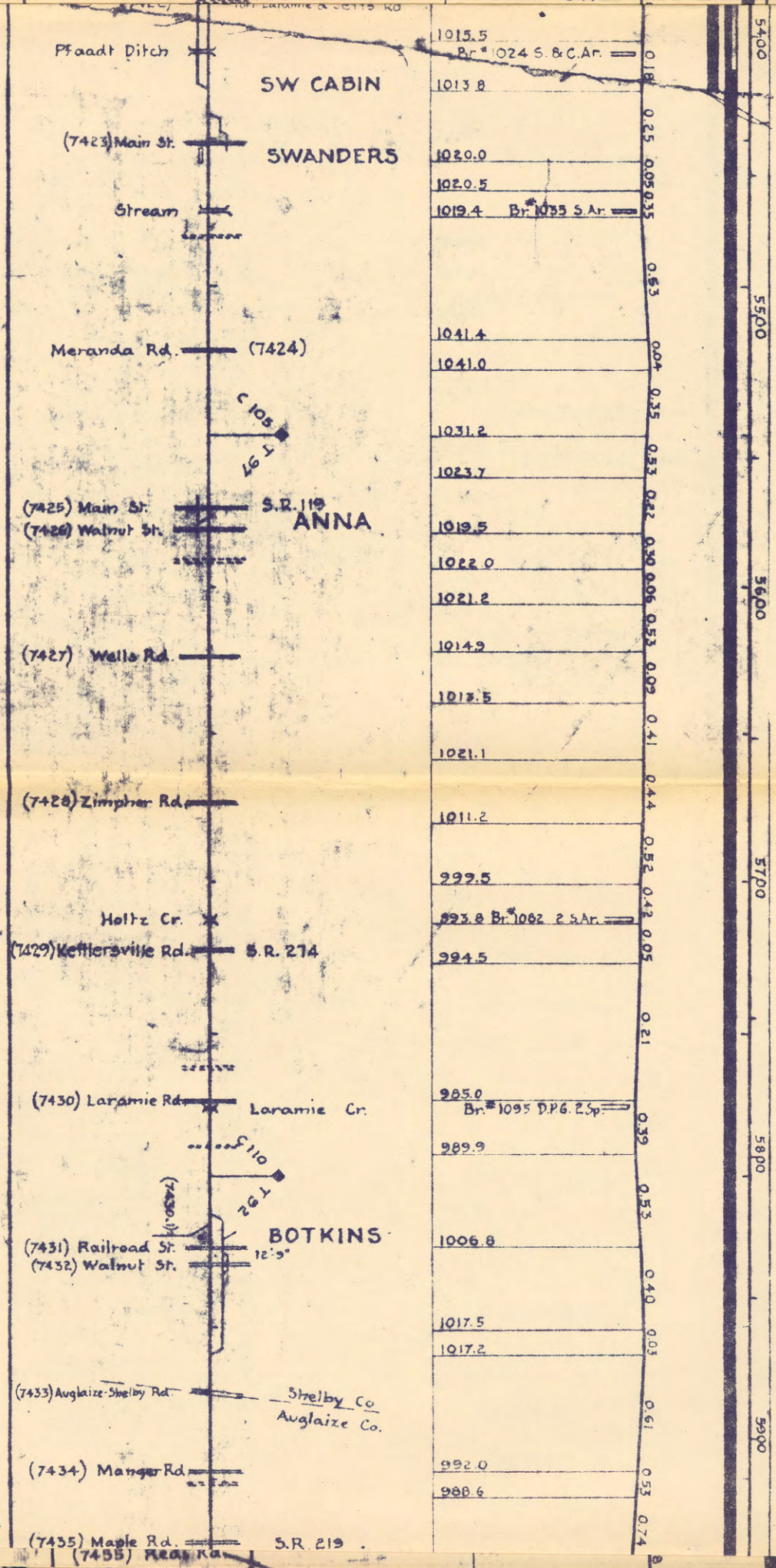

Pfadt Ditch

SW CABIN

(7423) Main St.

SWANDERS

Stream

Meranda Rd. (7424)

C 105
T 9

(7425) Main St.

S.R. 119

ANNA

(7426) Walnut St.

(7427) Wells Rd.

(7428) Zimpher Rd.

Holtz Cr.

(7429) Kettlersville Rd. S.R. 274

(7430) Laramie Rd. Laramie Cr.

S 110
T 9

(7431) Railroad St.
(7432) Walnut St.

BOTKINS
12'-5"

(7433) Auglaize-Shelby Rd. Shelby Co
Auglaize Co.

(7434) Manger Rd.

(7435) Maple Rd. S.R. 219
(7435) Maple Rd.

1015.5

Br. # 1024 S. & C. Ar.

1013.8

1020.0

1020.5

1019.4 Br. # 1035 S. Ar.

1041.4

1041.0

1031.2

1023.7

1019.5

1022.0

1021.2

1014.9

1013.5

1021.1

1011.2

999.5

993.8 Br. # 1062 2 S. Ar.

994.5

985.0

Br. # 1095 D.P.G. 2 Sp.

989.9

1006.8

1017.5

1017.2

992.0

988.6

5400
5500
5600
5700
5800
5900

0.18
0.25
0.05
0.35
0.63
0.04
0.35
0.53
0.22
0.50
0.06
0.53
0.09
0.41
0.44
0.52
0.42
0.05
0.21
0.39
0.53
0.40
0.03
0.61
0.53
0.74

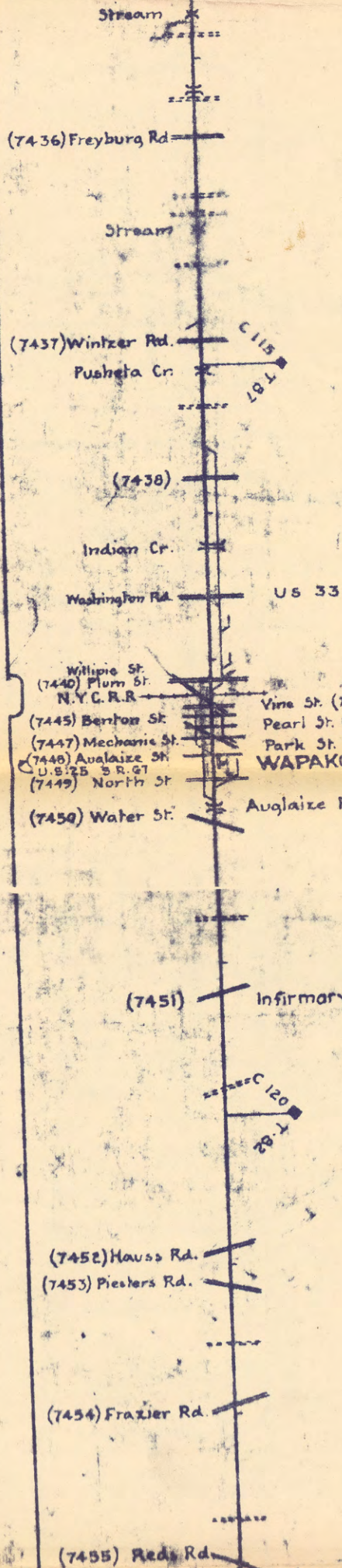

971.9	Br. #1127 S.Ar.	0.21
969.2		
	Br. #1132 R.T.	0.49
936.7	Br. #1141 S.&C.Ar.	0.36
932.3		0.54
923.7		
	Br. #1150 D.P.G.	0.19
912.2		
	Br. #1162 S.&C.Ar.	
	Br. #1165A OH	0.21
896.7		0.58
890.7		
	Br. #1180 D.P.G.25	0.46
924.0		0.28
926.5		0.22
921.2		0.26
915.5		0.42
905.0		0.02
905.3		0.05
904.1		0.13
903.0		0.04
903.0		
902.4		0.28

2°00'

6000
6100
6200
6300
6400
6500



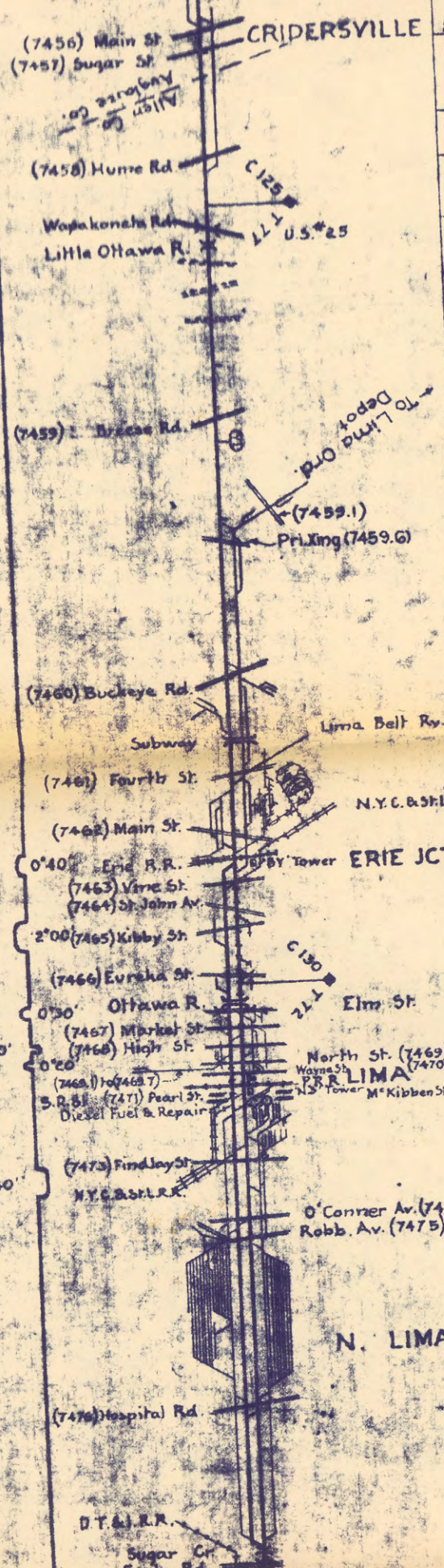

895.7	0.20
891.6	0.10
890.2	0.08
887.4	0.35
882.2	0.48
872.6	0.48
877.8	0.48
878.8	0.48
878.0	0.48
879.4	0.45
891.2	0.38
888.3	0.22
893.0	0.52
898.1	0.42
897.0	0.51
880.2	0.35
871.6	0.68
861.0	0.57
860.8	0.28
870.2	0.21
881.2	0.09
882.8	0.50
870.7	0.15
869.6	0.17
873.3	0.22
875.1	0.17
846.5	0.00

Joint Operation
N.Y.C. & S.H. - B. & O.

6600

6700

6800

6900

7000

Br. # 1251A OH.
Br. # 1252 T.P.G.

Br. # 1283 C Box

Br. # 1300 D.P.G.
Br. # 1301 D.P.G.

Br. # 1336

3-C. Ar.
Br. # 1337 C. Ar.

N. LIMA

ERIE JCT.

P.R.R. LIMA

D.T. & I.R.R.

D.T. & I.R.R.

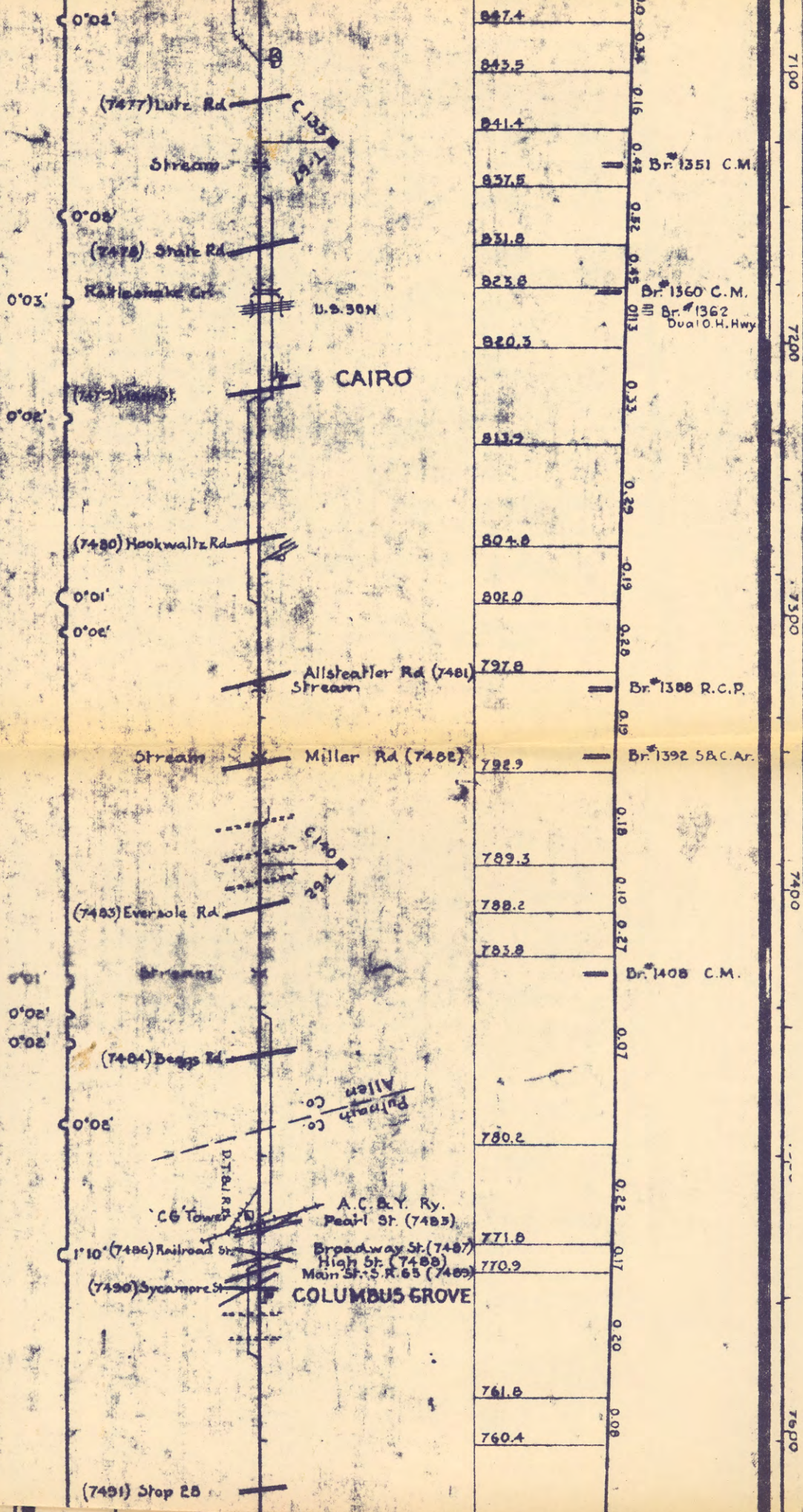

(7492) Stop 30

C 145

(7493) Klemm Rd.

Cranberry Cr.

(7495) Koch Rd.

0°02'

D.T. & I.R.R.

(7496) Baseline Rd.

Stream

(7497) Smith Rd.

0°02'

(7498)

S. OTTAWA
Williamstown Rd.

Blanchard R.

(7499) Second St.

(7501) Third St.

(7502) Fourth St.

Tawa Run

Main St. (7500)
OTTAWA

S.R. 05

(7503) Locust St.

(7504) Infirmary Rd.

1°00'

D.T. & I.R.R.

(7505) Klemm Rd.

Stream

(7506) S.R. 65

(7507) Angling Rd.

(7508) School House Rd.

(7509)

(7510)

C 185

D.T. & I.R.R.

752.1

750.4

747.7

746.1

741.3

739.9

739.2

739.2

728.8

747.4

746.4

747.8

749.5

757.7

767.0

770.5

778.6

773.6

0.12
0.05
0.10
0.08
0.12
0.10
0.04
0.0
0.14
0.32
0.04
0.06
0.15
0.33
0.44
0.36
0.01
0.19

Br # 1460 T.P.G.

Br # 1485 C & S. Ar.

Br # 1496 T.P.G. 35p P.P.G. 15p

Br # 1500 S. & C. Ar.

Br # 1521 C.M.

7700
7800
7900
8000
8100

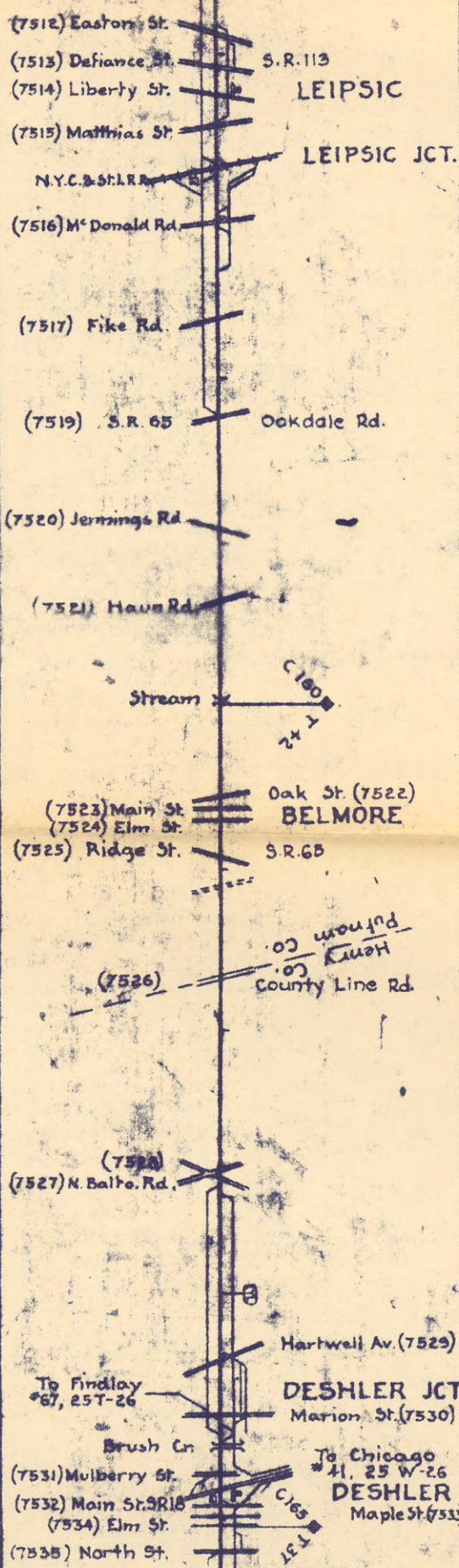

770.8	0.00
769.4	0.01
	0.02
757.9	0.03
	0.04
753.9	0.05
	0.06
	0.07
752.1	0.08
	0.09
746.0	0.10
	0.11
743.9	0.12
741.5	0.13
	0.14
738.8	0.15
	0.16
738.2	0.17
	0.18
735.4	0.19
	0.20
728.8	0.21
	0.22
723.9	0.23
	0.24
722.2	0.25
	0.26
	0.27
718.6	0.28
	0.29
	0.30
715.9	0.31
	0.32
	0.33
713.7	0.34
	0.35
713.7	0.36
	0.37
	0.38
712.6	0.39
	0.40
	0.41
710.4	0.42

Br. #1600 C.M.

Br. #1646 T.P.G.

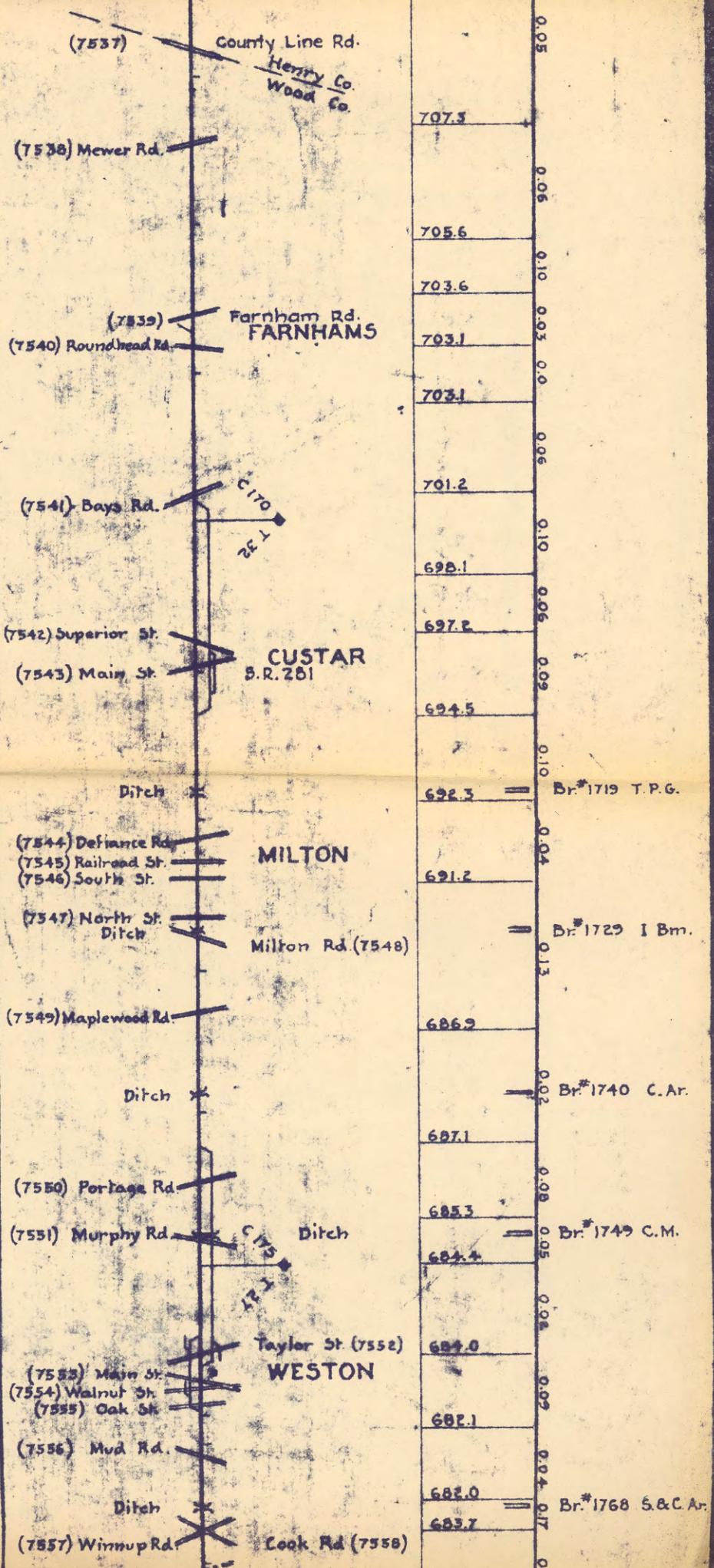

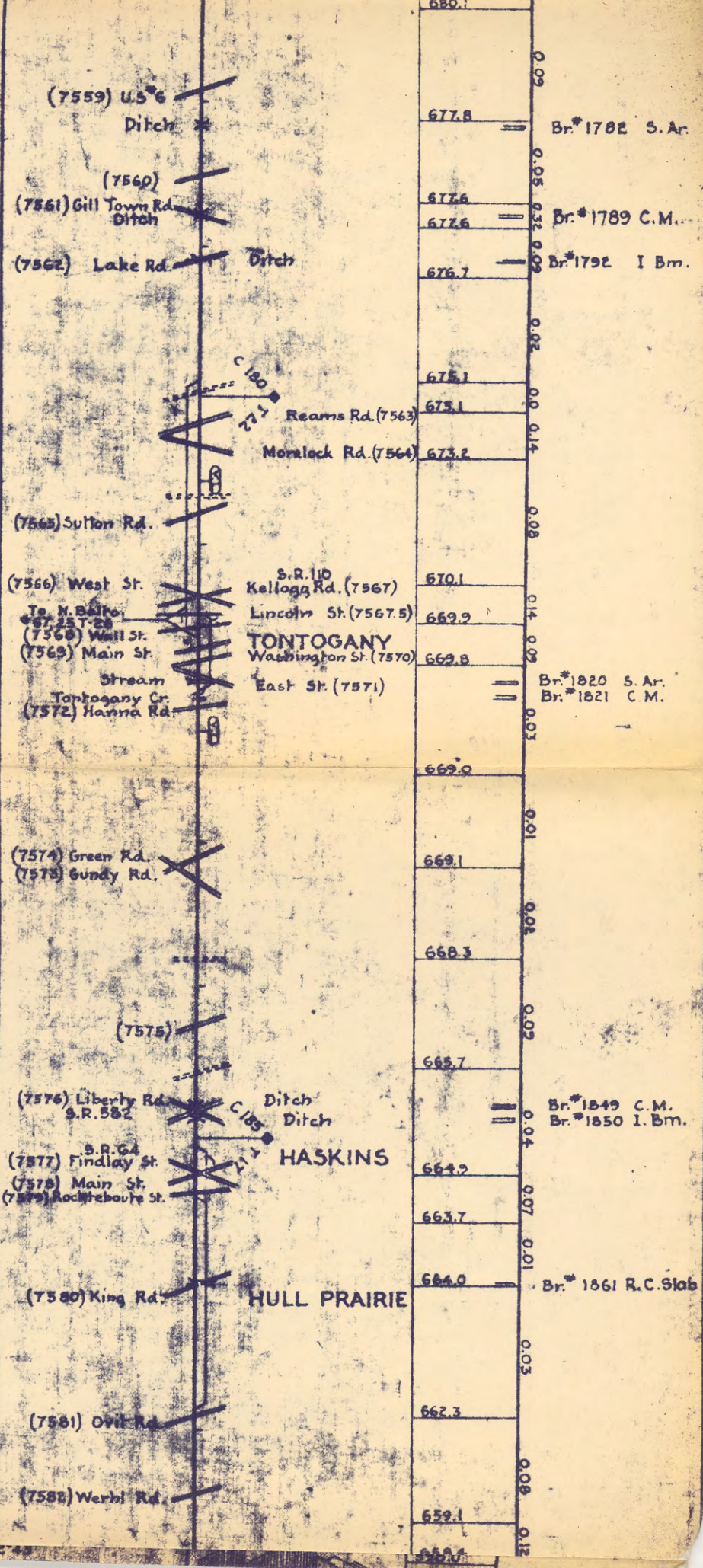

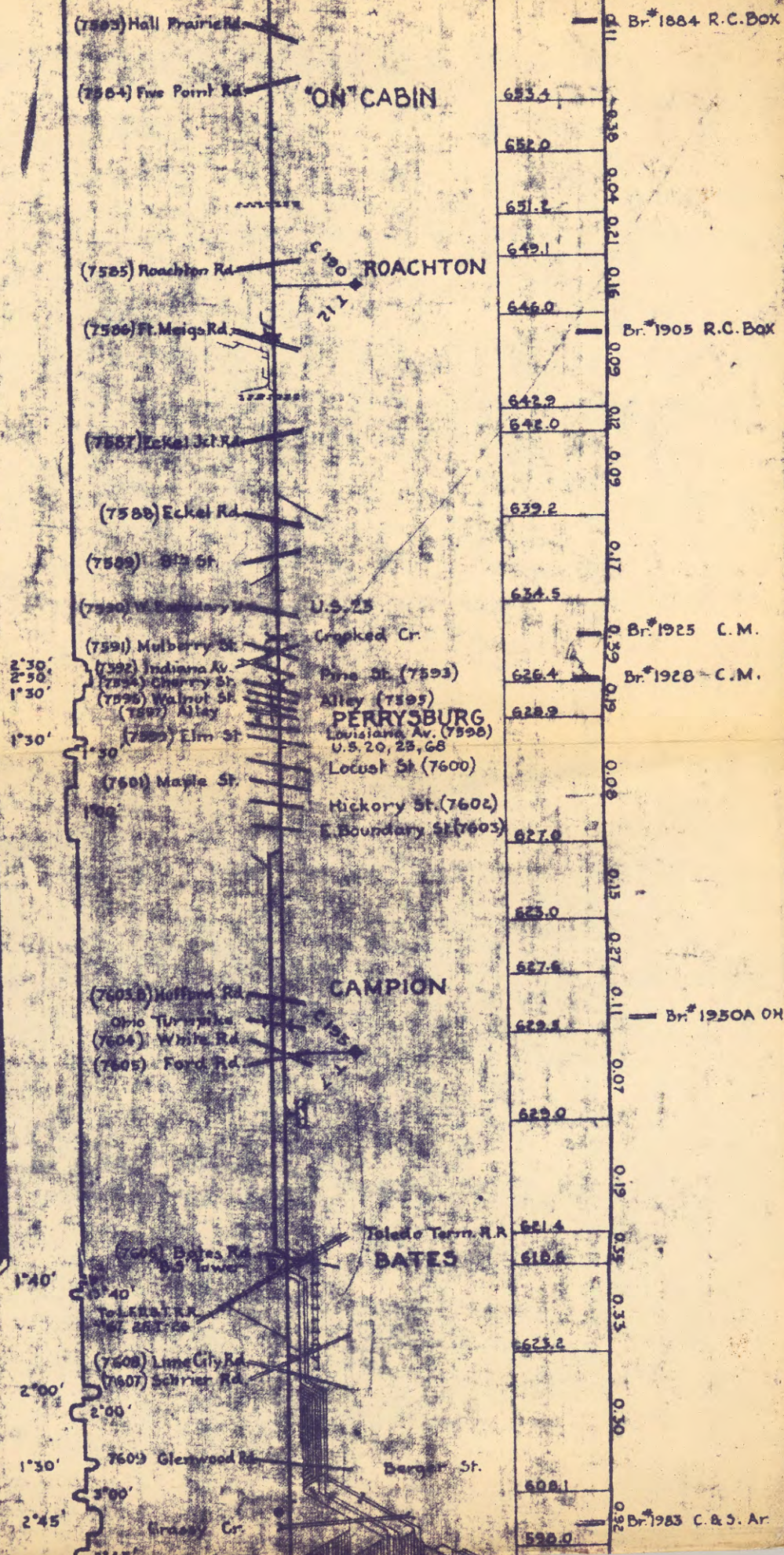

(7593) Hall Prairie Rd

Br. 1884 R.C. Box

(7564) Five Point Rd

"ON" CABIN

623.4

652.0

651.2

(7585) Roachton Rd

ROACHTON

649.1

646.0

(7586) Ft. Meigs Rd

Br. 1905 R.C. Box

642.9

642.0

(7567) Eckel Rd

639.2

(7588) Eckel Rd

634.5

(7589) 8th St

Br. 1925 C.M.

626.4

(7590) S. Boundary St

U.S. 25

Br. 1928 C.M.

(7591) Mulberry St

Cranked Cr.

628.9

(7592) Indiana Av

Pine St. (7593)

(7593) Cherry St

Alley (7595)

(7596) Walnut St

PERRYSBURG
Louisiana Av. (7598)
U.S. 20, 23, 68

627.0

(7597) Alley

Locust St (7600)

(7599) Elm St

Hickory St. (7602)

(7600) Maple St

S. Boundary St (7603)

625.0

627.6

(7603) Huffard Rd

CAMPION

622.8

Br. 1950A OH

Ohio Turnpike

(7604) White Rd

(7605) Ford Rd

629.0

621.4

Islede Term. R.R.

BATES

618.6

(7606) Bates Rd

(7607) Schrier Rd

623.2

(7608) Lime City Rd

628.1

(7609) Glesswood Rd

Barger St.

628.1

(7609) Glesswood Rd

Br. 1983 C. & S. Ar.

590.0

(7609) Glesswood Rd

(7609) Glesswood Rd

(7609) Glesswood Rd

2'30'
2'50'
1'30'
1'30'

1'40'
1'40'
2'00'
2'00'
1'30'
3'00'
2'45'
2'45'

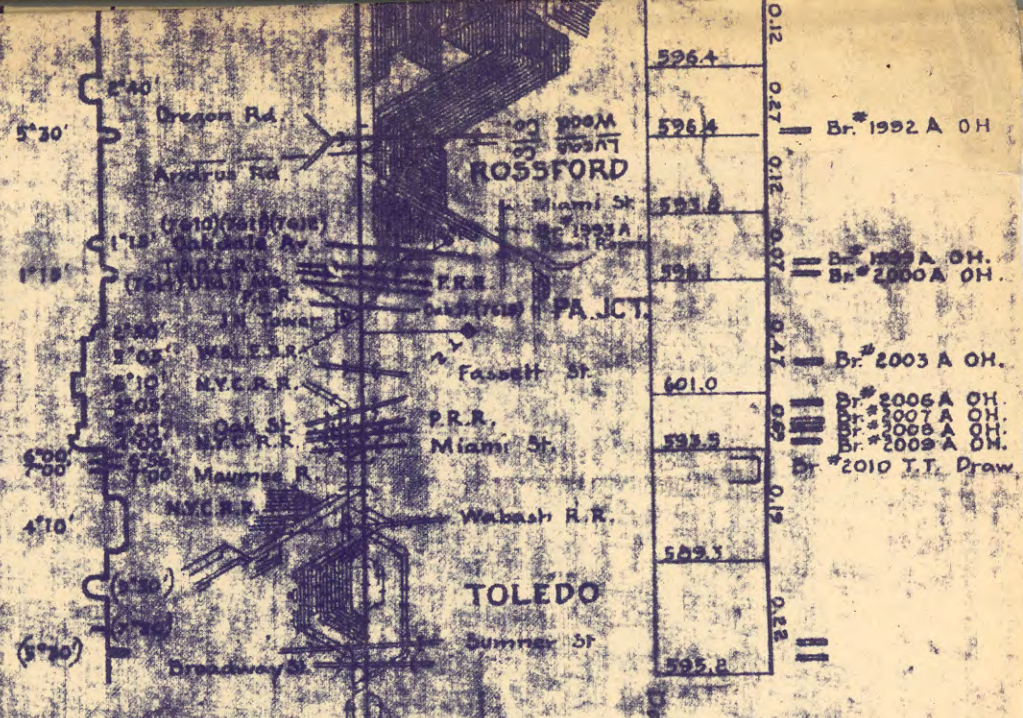

Dalbury 200

N.C.C. bridge

**BALTIMORE AND OHIO SYSTEM
WESTERN REGION
TOLEDO-INDIANAPOLIS DIV
CINCINNATI**

Track Chart A
Scale 1" = 100'
Office of C.E.
Baltimore

RAIL

140 lb. or 131 lb.	— — — — —
112 lb. or 115 lb.	— — — — —
100 lb.	— — — — —
Less than 100 lb.	— — — — —

BALLAST

Stone or Crushed slag	— — — — —
Gravel	— — — — —
Cinder or Granulated Slag	— — — — —

Gravel's shown are standard
Elevations are top of Low Rail

SYMBOLS

Depot	— — — — —
Platform	— — — — —
Tower	— — — — —
Water Tank	— — — — —
Water Column	— — — — —
Turntable	— — — — —
Track Scale	— — — — —
Coaling Station	— — — — —
Public Road Crossing	— — — — —
Private Road Crossing	— — — — —
Road Crossing	— — — — —